

/ TENDE VENEZIANE manuale tecnico

PLASTIND'S 2.0
since 1955

/ INDICE

/ 1 INTRODUZIONE

DESCRIZIONE DEL PRODOTTO

La Tenda Veneziana "Top Down" è indicata per le finestre che si aprono a vasista. Il cassonetto superiore e il terminale inferiore si possono posizionare nell'altezza desiderata tramite una movimentazione manuale.

Due corde di tensionamento passano attraverso il cassonetto, il terminale e le lamelle e mantengono la tenda nella posizione desiderata.

L'orientamento delle lamelle avviene attraverso un perno sul cassonetto. Non è necessario eseguire dei fori sull'infisso perché la tenda si ancora a due profili a "C" che si attaccano al vetro tramite un biadesivo.

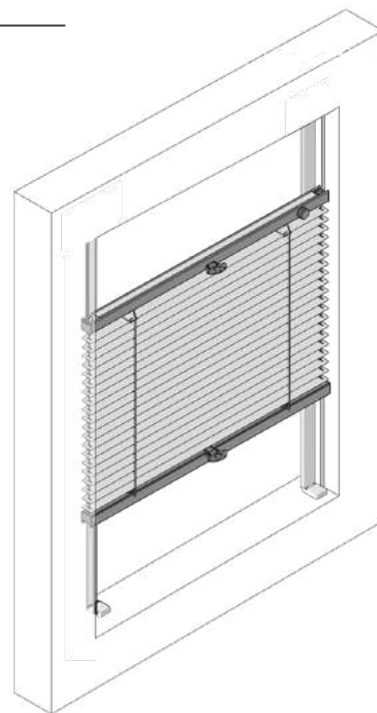

LIMITI DIMENSIONALI

	Min. Larghezza	Max. Larghezza	Min. Altezza	Max. Altezza	Max. Superficie
16 mm	270 mm	1420 mm	200 mm	2300 mm	2 m ²
25 mm	270 mm	1500 mm	200 mm	2500 mm	2 m ²

/ 2 MISURAZIONE

COME PRENDERE CORRETTAMENTE LE MISURE

È possibile prendere le misure dividendo le finestre in 3 categorie

A - Finestre con la guarnizione inferiore a 5 mm

B - Finestre con la guarnizione di larghezza maggiore di 5 mm e di spessore inferiore a 5 mm

C - Finestre con la guarnizione maggiore di 5 mm

Per la maggior parte delle finestre in Pvc, il metodo A è il più usato.

Per la maggior parte delle finestre in Alluminio, si utilizza il metodo B o C.

METODO A

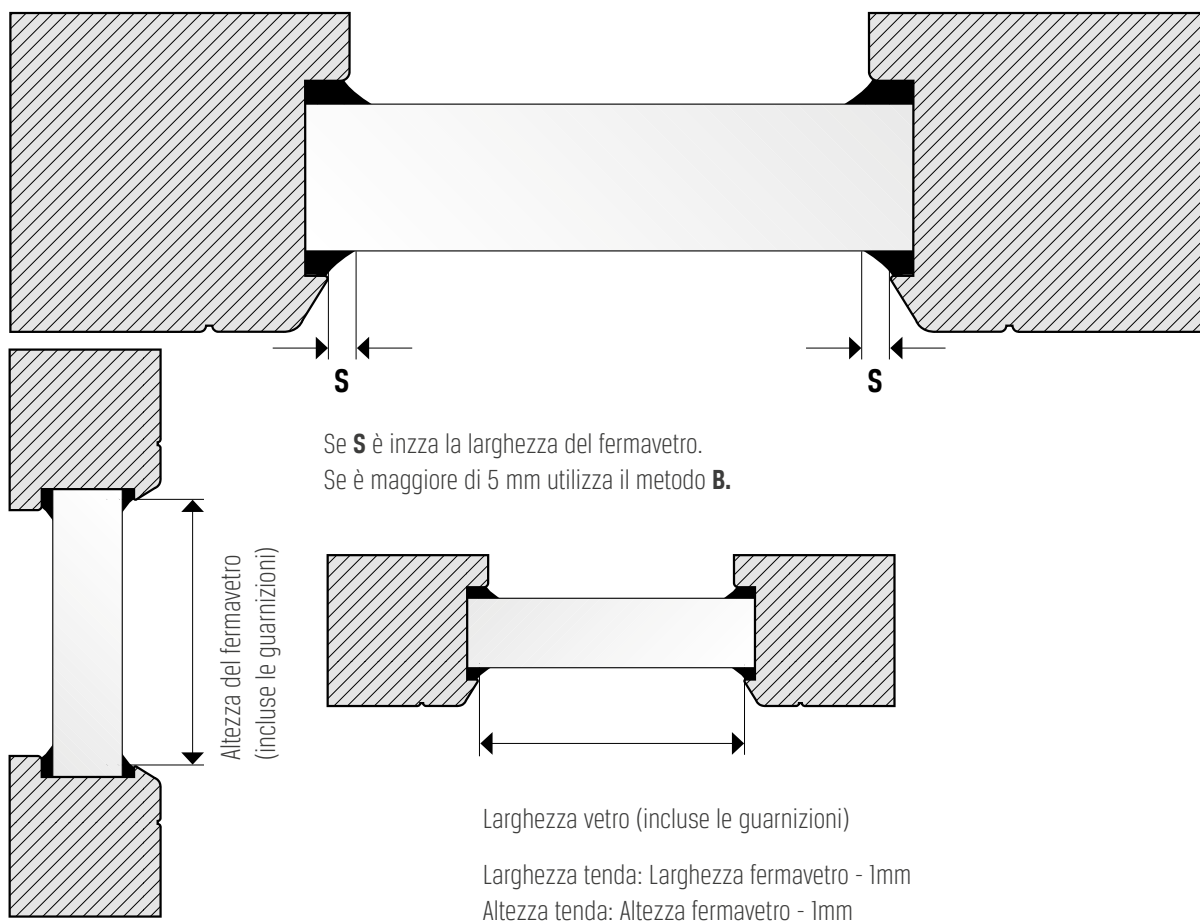

VISTA LATERALE

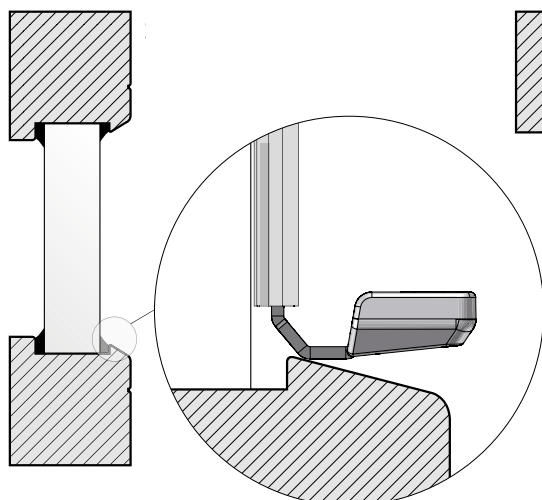

VISTA SUPERIORE

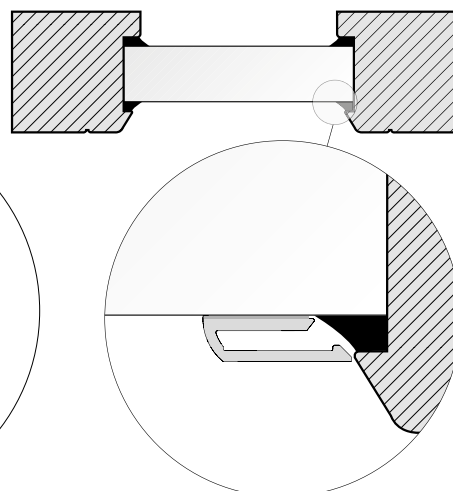

Il profilo a C compensa la dimensione della guarnizione.

METODO B

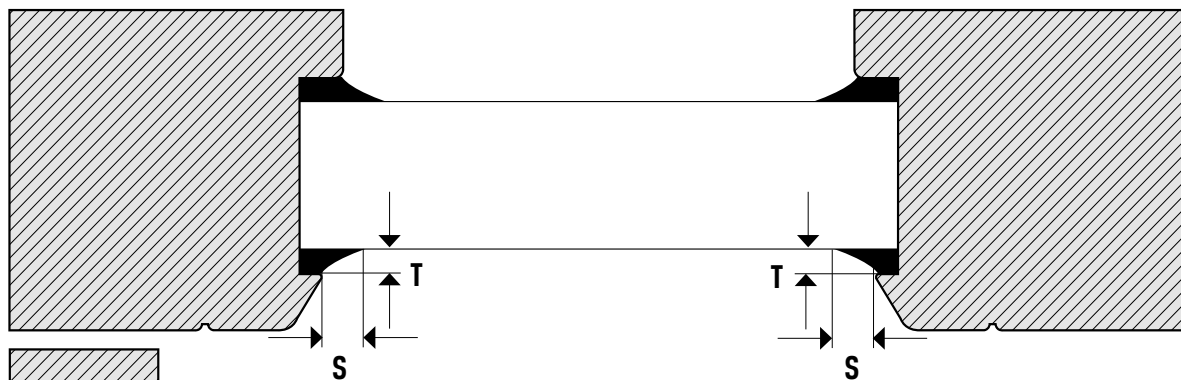

Se **S** è maggiore di 5 mm e **T** è inferiore di 5 mm, misura la larghezza e altezza del vetro.
Se **T** è maggiore di 5 mm, utilizza il metodo **C**.

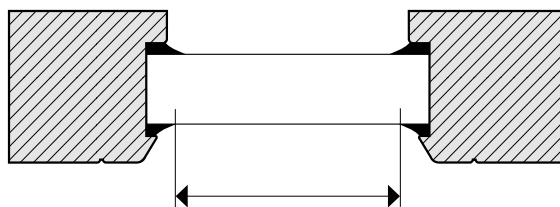
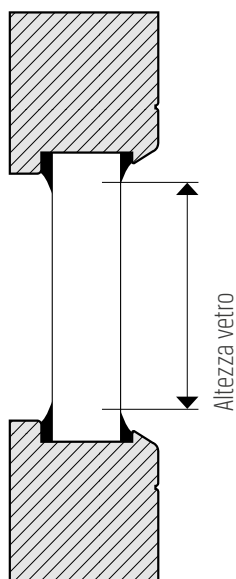

Larghezza vetro

Larghezza tenda: Larghezza vetro + 7mm

Altezza tenda: Altezza vetro + 7mm

VISTA LATERALE

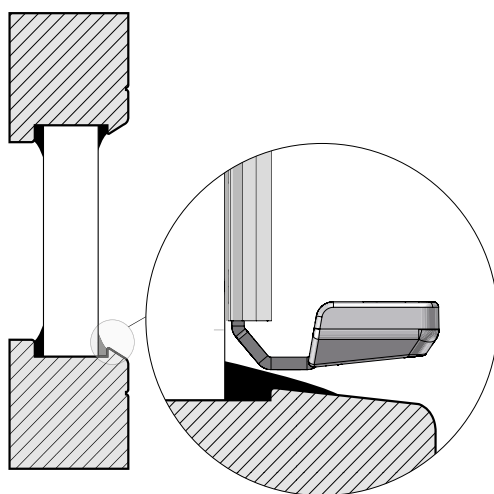

VISTA SUPERIORE

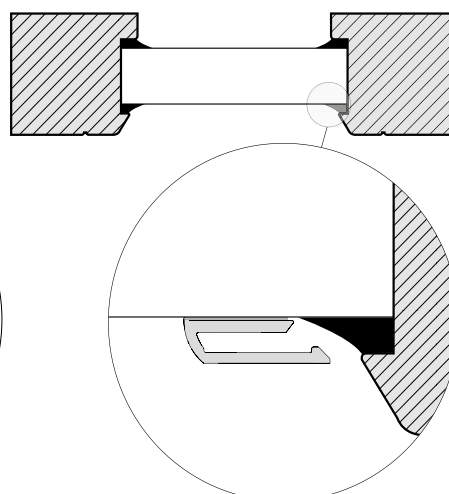

Il profilo a C compensa in parte la dimensione della guarnizione.

METODO C

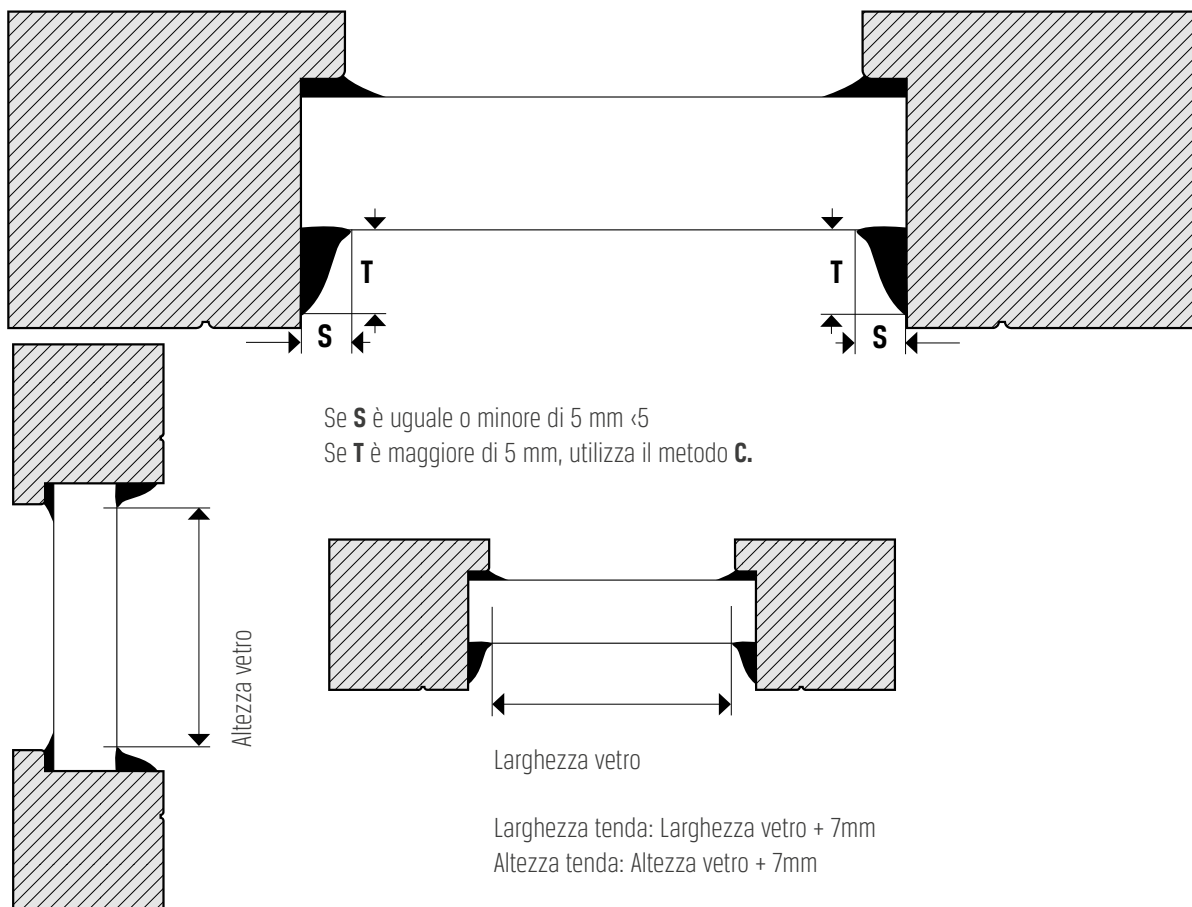

VISTA LATERALE

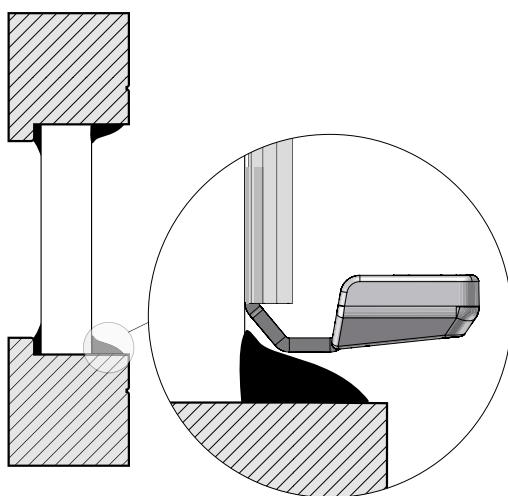

VISTA SUPERIORE

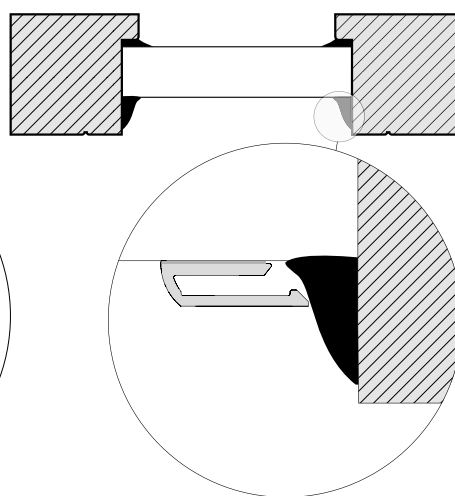

/ 3 ESPLOSO

VISTA ESPLOSA

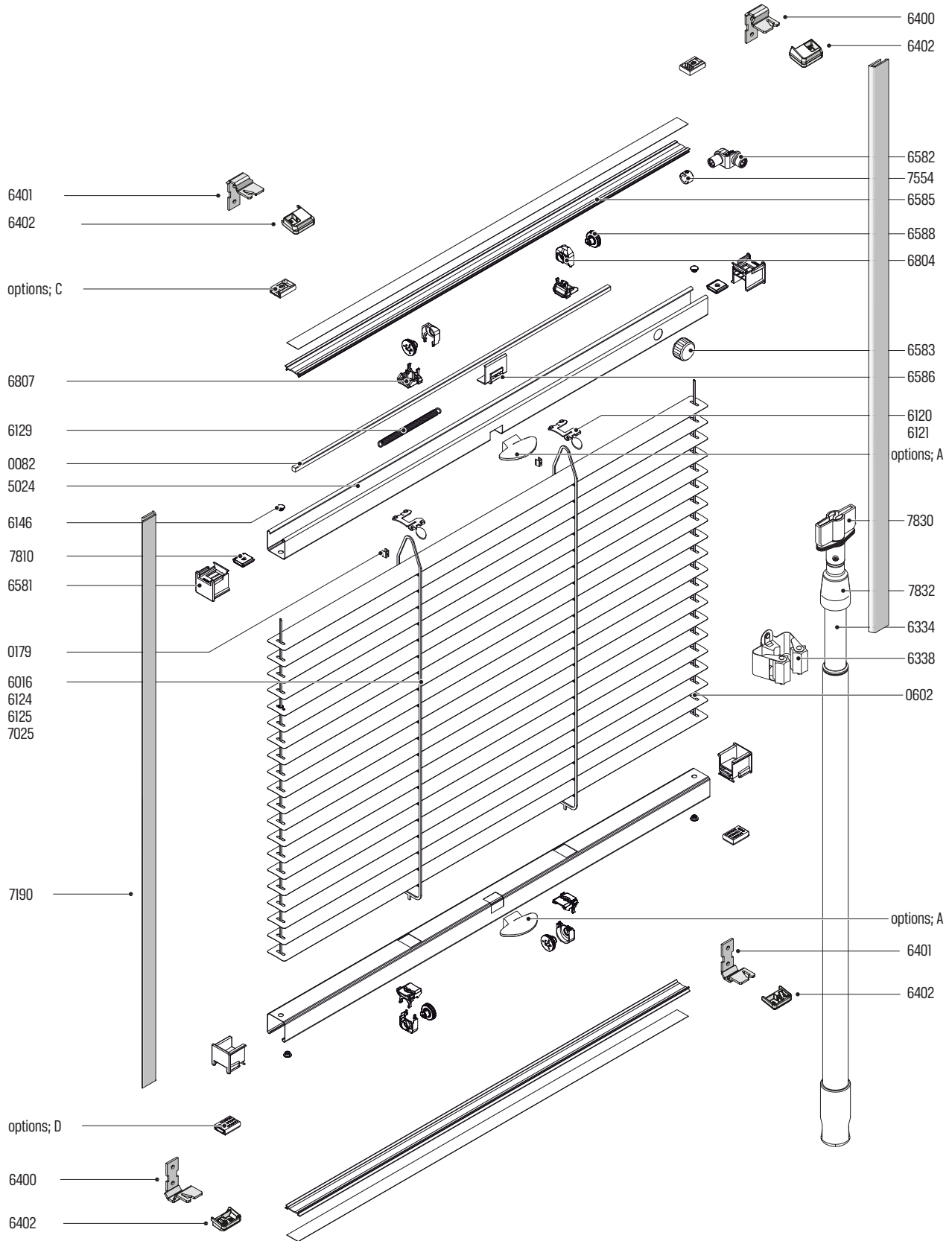

OPZIONI A/B

Option A

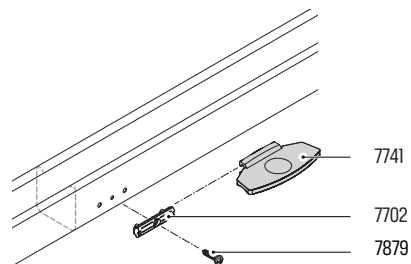
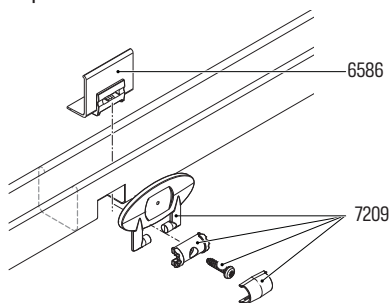

Option C

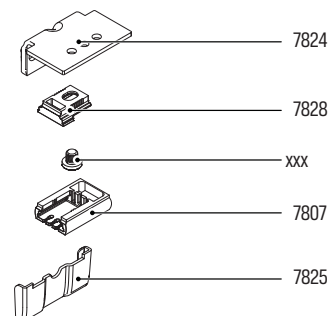
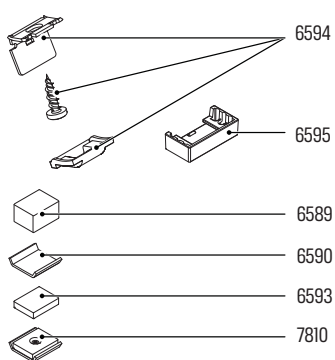
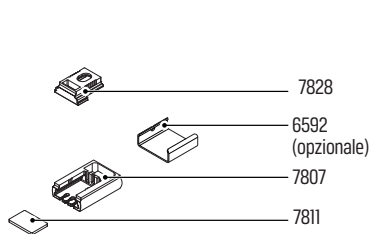

Option D

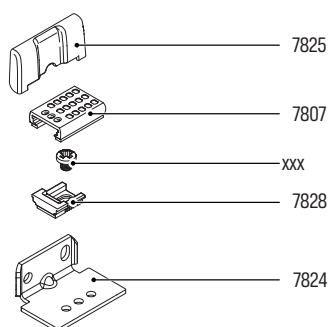
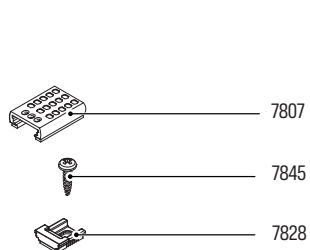

/ 4 MONTAGGIO

1. TAGLIARE A MISURA

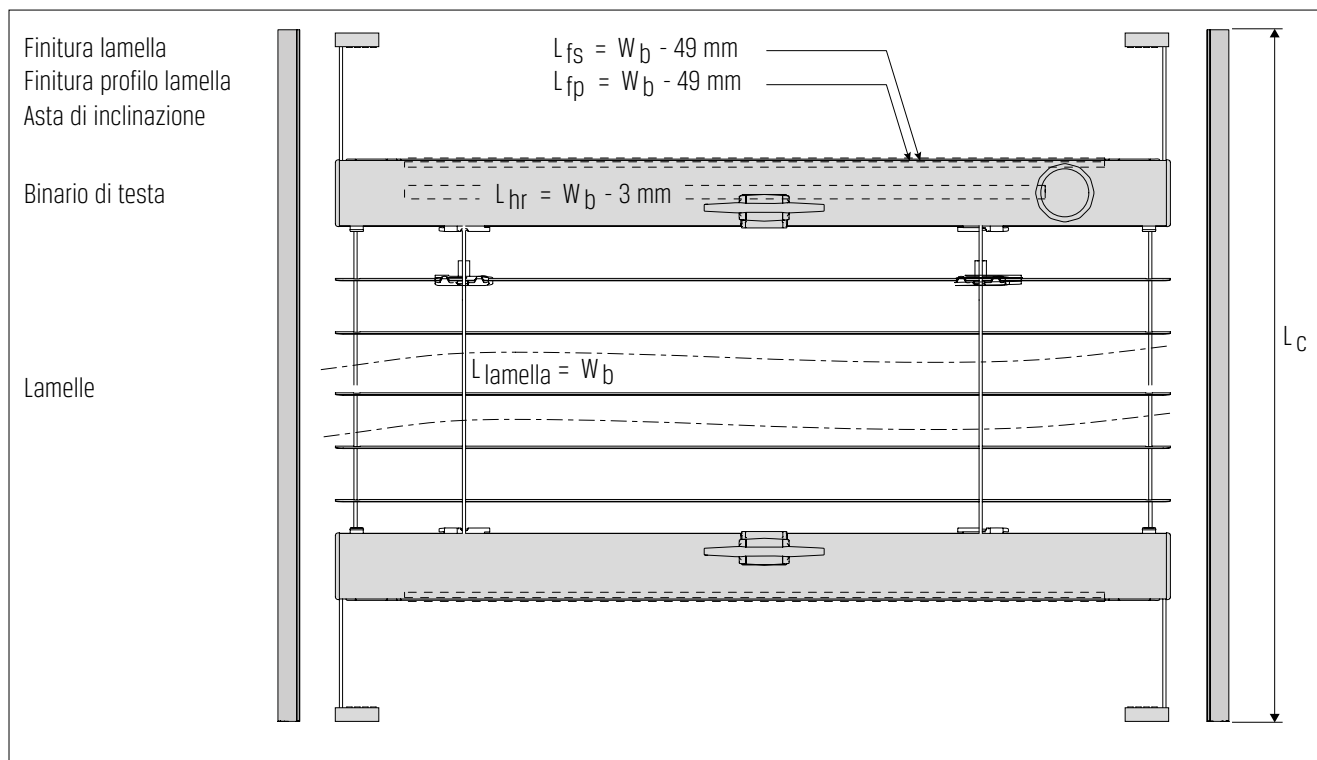

2. PANORAMICA DEI CALCOLI

Parte	Calcolo
Larghezza tenda	$W_b =$ Misura la larghezza della finestra - 2 mm
Altezza tenda	$H_b =$ Altezza della finestra misurata
Lunghezza binario di testa	$L_{hr} =$ Larghezza tenda - 3 mm
Finitura lunghezza lamelle	$L_{fs} =$ Larghezza tenda - 49 mm
Finitura profilo lunghezza lamelle	$L_{fp} =$ Larghezza tenda - 49 mm
Lunghezza asta di inclinazione	$L_{tr} =$ Larghezza tenda - 155 mm
Lunghezza guida inferiore	$L_{br} =$ Larghezza tenda - 3 mm
Lunghezza nastro della corda	$L_{st} =$ Altezza cieca - 12 mm
Lunghezza: lamelle	$L_{slats} =$ Larghezza tenda
Lunghezza profilo C	$L_c =$ Larghezza tenda - 11 mm
Lamelle: quantità, 16 mm	$Slats = \frac{\text{Altezza tenda} - 48 \text{ mm}}{12}$
Lamelle: quantità, 25 mm	$Slats = \frac{\text{Altezza tenda} - 36 \text{ mm}}{20}$
Lunghezza dei cavi di tensione	$L_{tc} =$ 2 x Altezza tenda + 4 x Spessore tenda + 200 mm

3. FORI DI PERFORAZIONE NELLA GUIDA DI TESTATA

Lamelle 16 mm

Larghezza tenda (mm)	Fine distanza Y (mm)	Distanza intermedia X (mm)	Numero di corde	Numero di maniglie
- 500	90	Larghezza -180	2	1
500 - 620	110	Larghezza -220	2	1
621 -1020	110	(Larghezza -220) :2	3	2
1021 - 1420	110	(Larghezza -220) :3	4	2

Lamelle 25 mm

Larghezza tenda (mm)	Fine distanza Y (mm)	Distanza intermedia X (mm)	Numero di corde	Numero di maniglie
- 500	90	Larghezza -180	2	1
500 - 620	110	Larghezza -220	2	1
621 - 900	150	Larghezza -300	2	1
901 - 1500	150	(Larghezza -300) :2	3	2

A = Fori per nastro corde B = Fori del cavo di tensione C = Foro manopola ribaltatore D = Foro maniglia

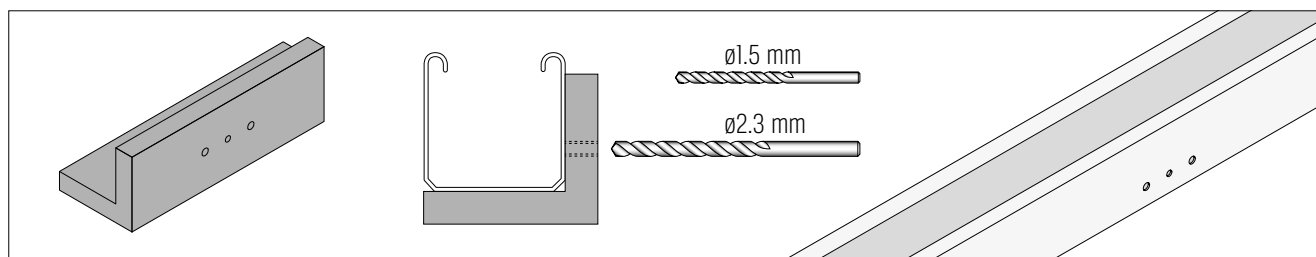
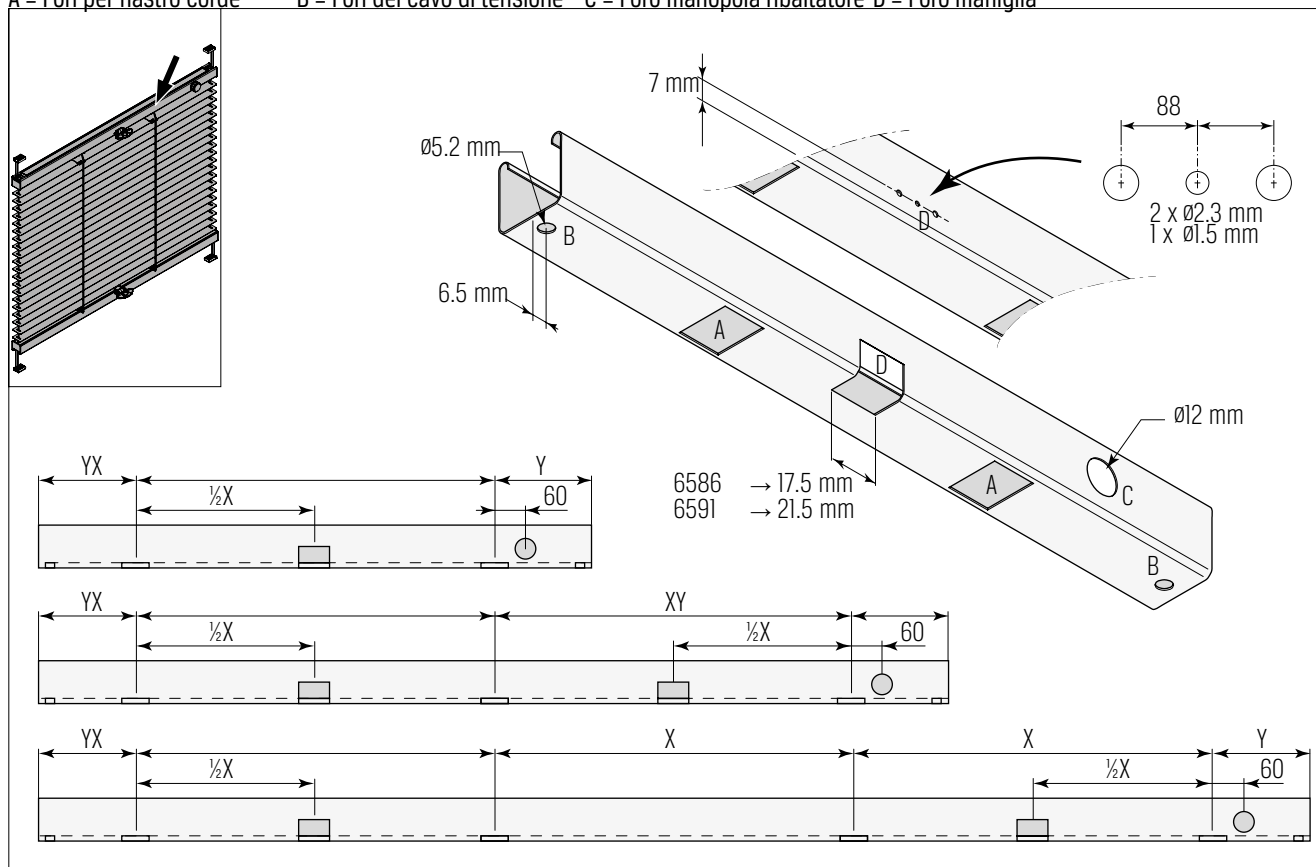

4. BINARIO INFERIORE

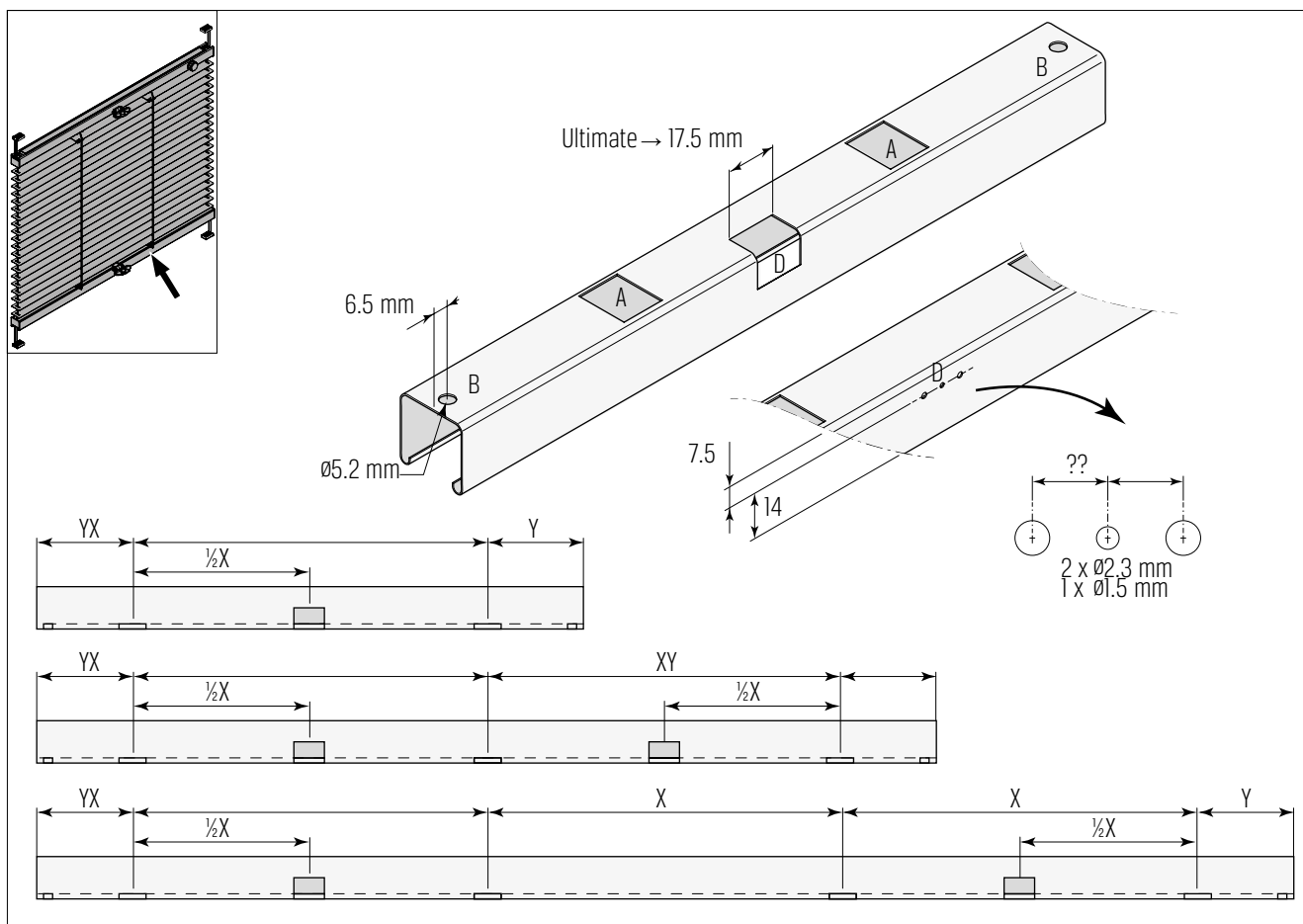

A = Fori per nastro corde B = Fori del cavo di tensione D = Foro maniglia

5. INSERIRE GLI OCCHIELLI

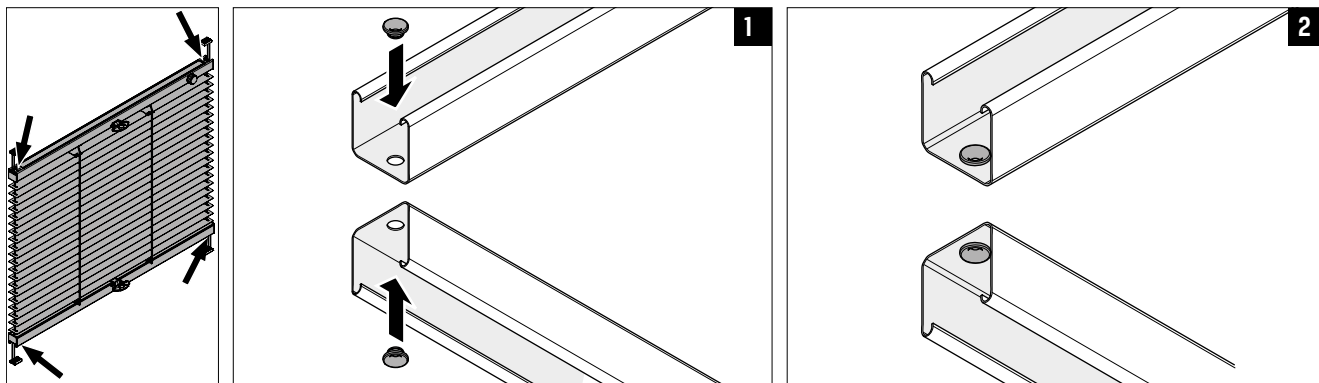

6. ATTACCARE LA MANIGLIA

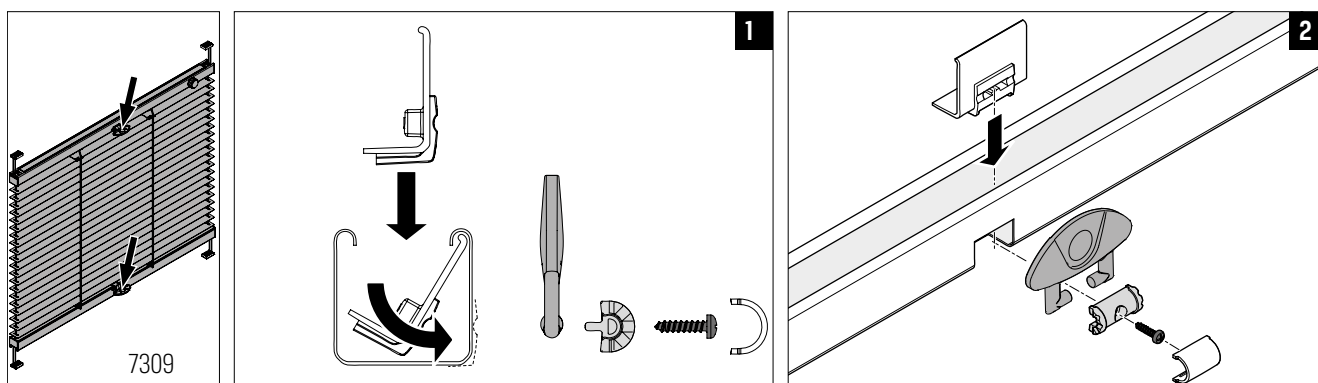

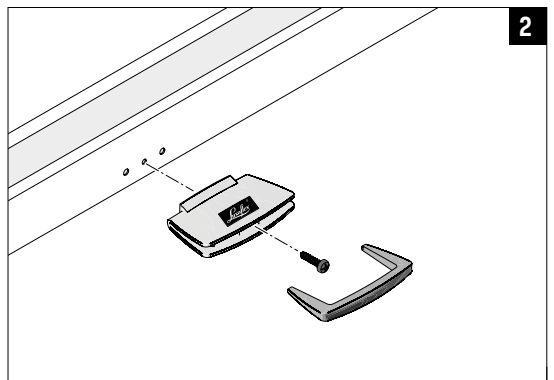
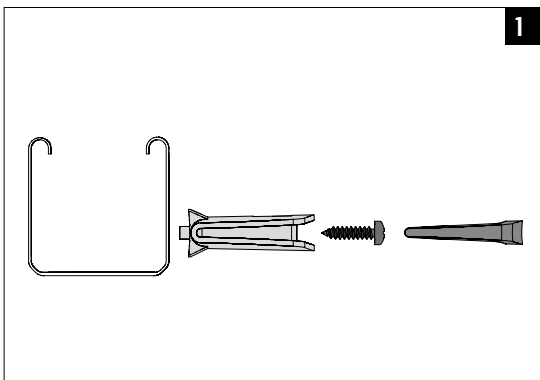
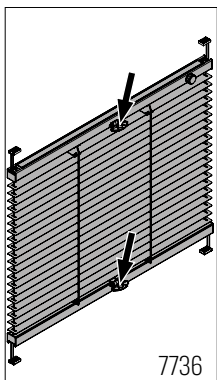
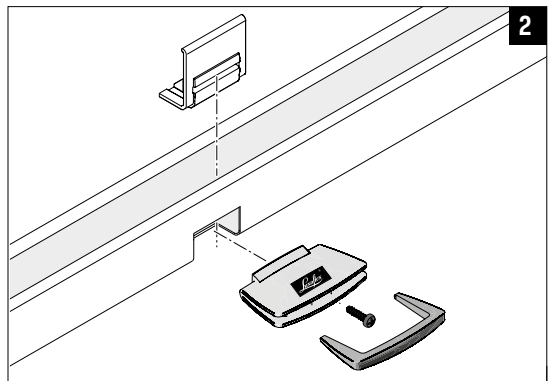
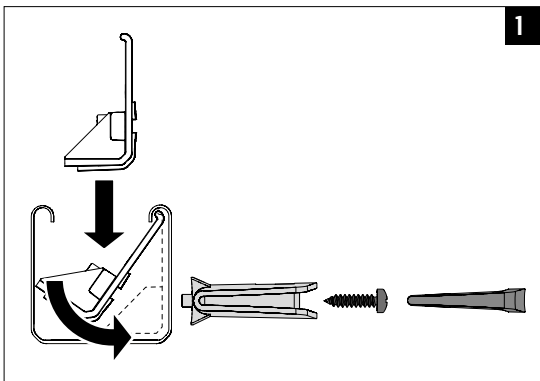
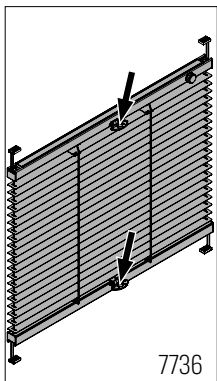
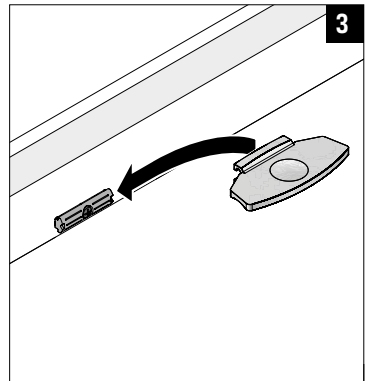
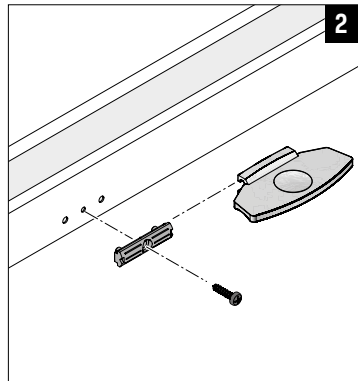
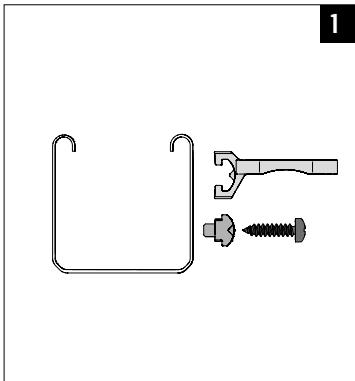
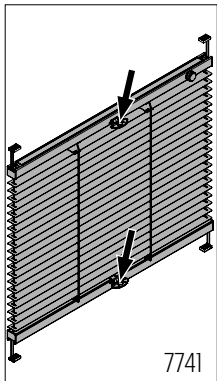
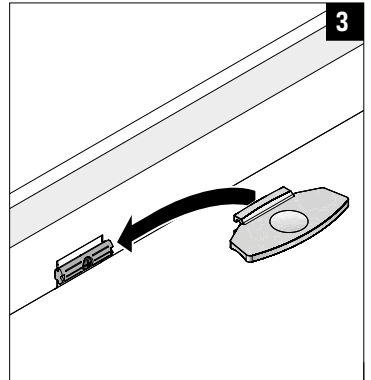
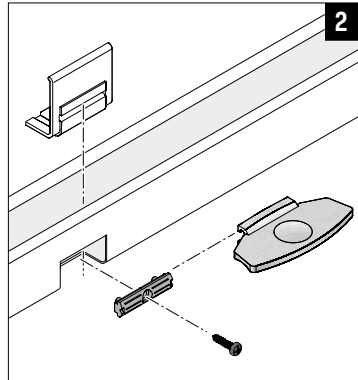
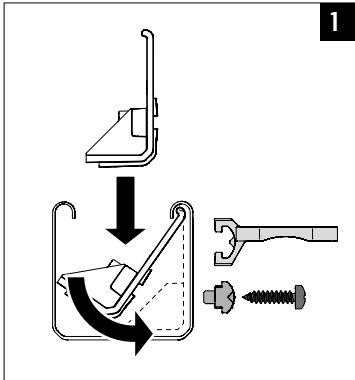
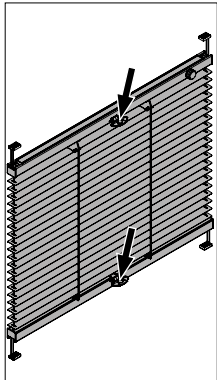
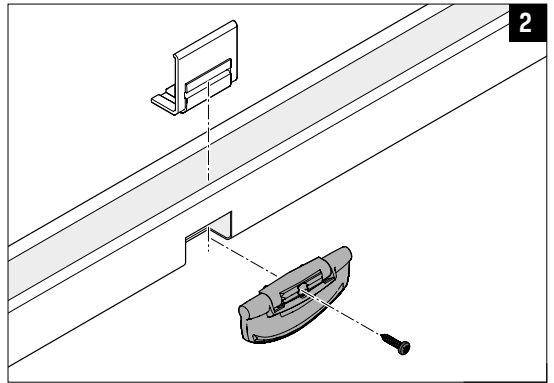
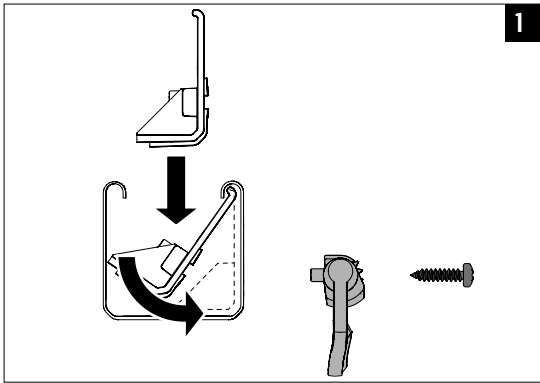
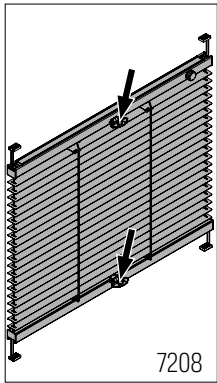

7. PREPARARE LE CAPSULE TERMINALI

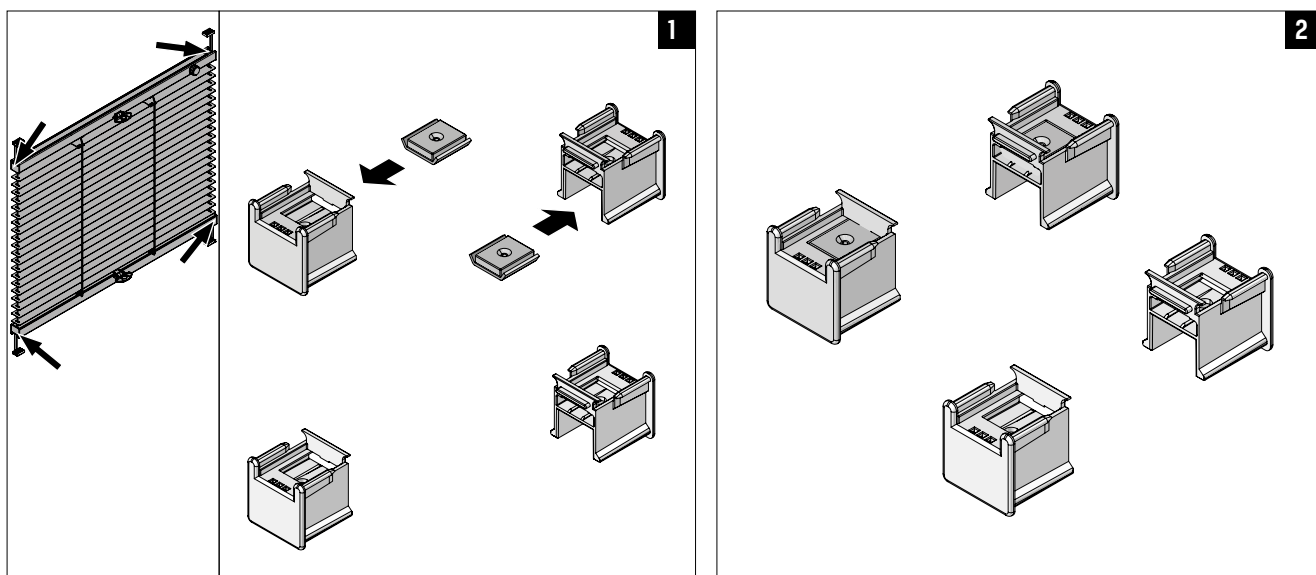

8. PREPARARE LA LAMELLA DI FINITURA

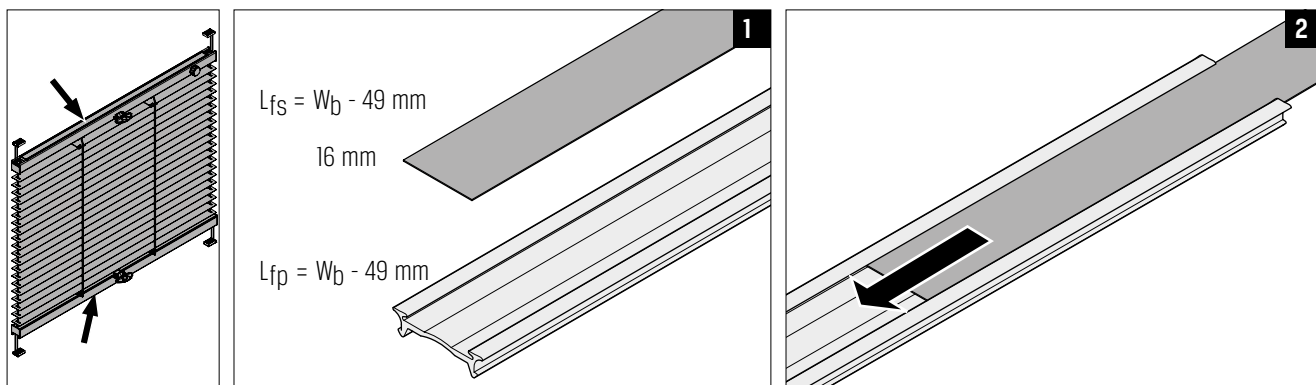

9. PREPARARE IL NASTRO DI STRINGA

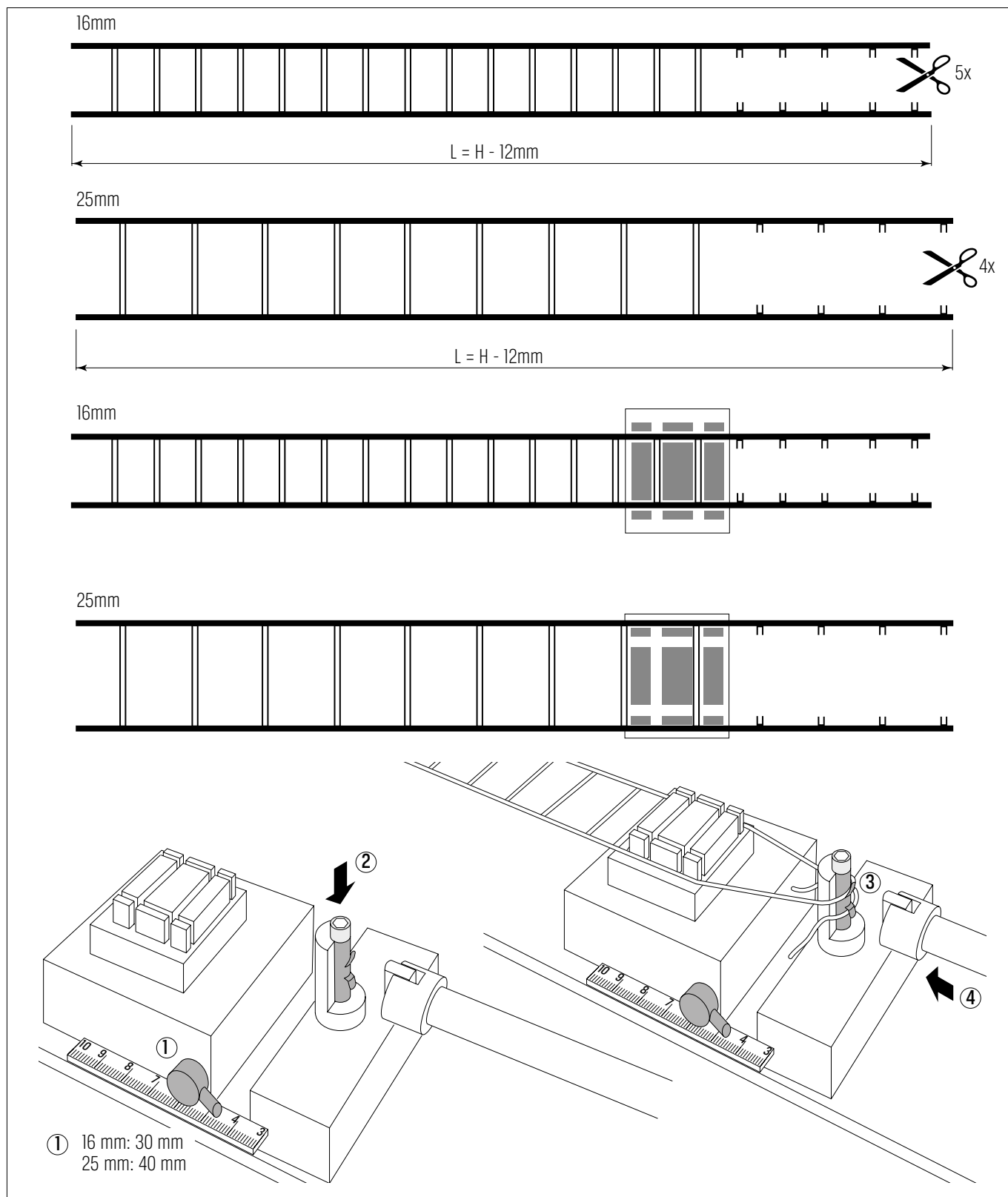

10. FISSAGGIO DEL CORDONCINO

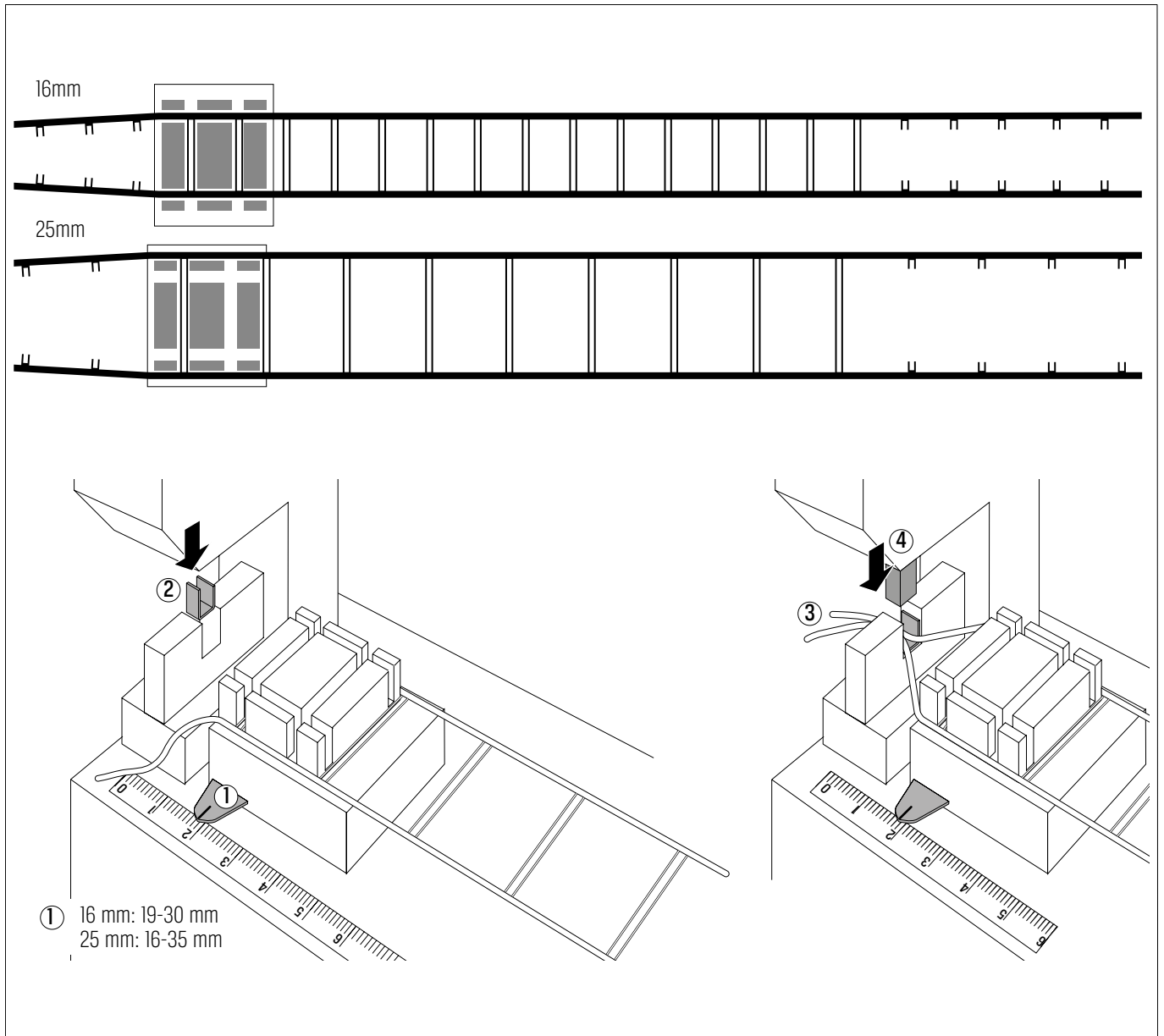

11. NUMERO DI LAMELLE

Lamelle 16 mm

Altezza (mm)	Numero di lamelle	Altezza (mm)	Numero di lamelle	Altezza (mm)	Numero di lamelle	Altezza (mm)	Numero di lamelle
456	34	924	73	1392	112	1860	151
468	35	936	74	1404	113	1872	152
480	36	948	75	1416	114	1884	153
492	37	960	76	1428	115	1896	154
504	38	972	77	1440	116	1908	155
516	39	984	78	1452	117	1920	156
528	40	996	79	1464	118	1932	157
540	41	1008	80	1476	119	1944	158
552	42	1020	81	1488	120	1956	159
564	43	1032	82	1500	121	1968	160
576	44	1044	83	1512	122	1980	161
588	45	1056	84	1524	123	1992	162
600	46	1068	85	1536	124	2004	163
612	47	1080	86	1548	125	2016	164
624	48	1092	87	1560	126	2028	165
636	49	1104	88	1572	127	2040	166
648	50	1116	89	1584	128	2052	167
660	51	1128	90	1596	129	2064	168
672	52	1140	91	1608	130	2076	169
684	53	1152	92	1620	131	2088	170
696	54	1164	93	1632	132	2100	171
708	55	1176	94	1644	133	2112	172
720	56	1188	95	1656	134	2124	173
732	57	1200	96	1668	135	2136	174
744	58	1212	97	1680	136	2148	175
756	59	1224	98	1692	137	2160	176
768	60	1236	99	1704	138	2172	177
780	61	1248	100	1716	139	2184	178
792	62	1260	101	1728	140	2196	179
804	63	1272	102	1740	141	2208	180
816	64	1284	103	1752	142	2220	181
828	65	1296	104	1764	143	2232	182
840	66	1308	105	1776	144	2244	183
852	67	1320	106	1788	145	2256	184
864	68	1332	107	1800	146	2268	185
876	69	1344	108	1812	147	2280	186
888	70	1356	109	1824	148	2292	187
900	71	1368	110	1836	149	2304	188
912	72	1380	111	1848	150		

Per dimensioni intermedie prendere il numero di doghe immediatamente superiore.

Lamelle 25 mm

Altezza (mm)	Numero di lamelle	Altezza (mm)	Numero di lamelle	Altezza (mm)	Numero di lamelle	Altezza (mm)	Numero di lamelle
436	20	976	47	1516	74	2056	101
456	21	996	48	1536	75	2076	102
476	22	1016	49	1556	76	2096	103
496	23	1036	50	1576	77	2116	104
516	24	1056	51	1596	78	2136	105
536	25	1076	52	1616	79	2156	106
556	26	1096	53	1636	80	2176	107
576	27	1116	54	1656	81	2196	108
596	28	1136	55	1676	82	2216	109
616	29	1156	56	1696	83	2236	110
636	30	1176	57	1716	84	2256	111
656	31	1196	58	1736	85	2276	112
676	32	1216	59	1756	86	2296	113
696	33	1236	60	1776	87	2316	114
716	34	1256	61	1796	88	2336	115
736	35	1276	62	1816	89	2356	116
756	36	1296	63	1836	90	2376	117
776	37	1316	64	1856	91	2396	118
796	38	1336	65	1876	92	2416	119
816	39	1356	66	1896	93	2436	120
836	40	1376	67	1916	94	2456	121
856	41	1396	68	1936	95	2476	122
876	42	1416	69	1956	96	2496	123
896	43	1436	70	1976	97	2516	124
916	44	1456	71	1996	98		
936	45	1476	72	2016	99		
956	46	1496	73	2036	100		

Per dimensioni intermedie prendere il numero di doghe immediatamente superiore.

12. TAGLIE E ALLACCIA LE LAMELLE

Impostare la lunghezza corretta delle lamelle e le distanze finali sulla macchina.

La macchina per lamelle taglia, perfora e allaccia le lamelle.

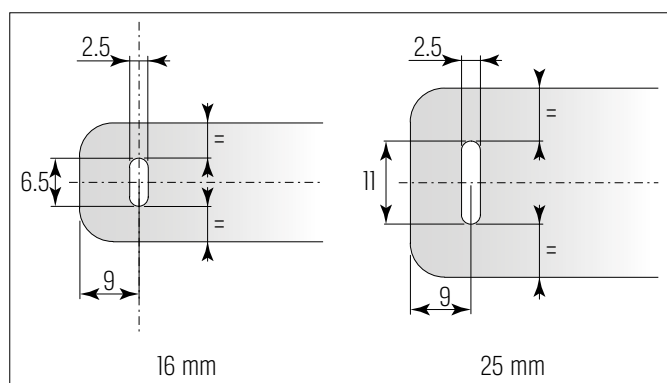

13. POSIZIONARE I SUPPORTI DEL ROTOLO DI NASTRO

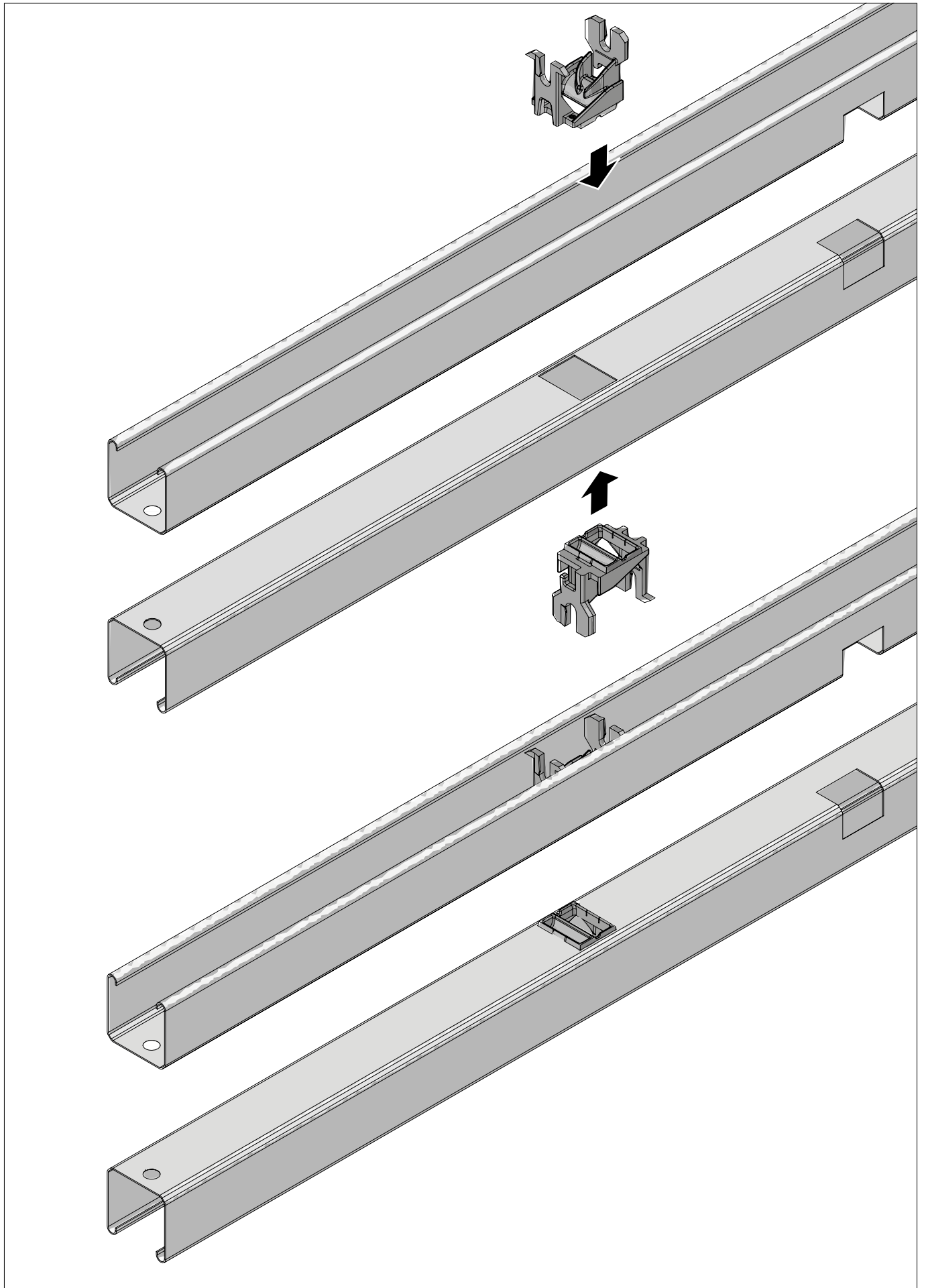

14. ATTACCARE IL PACCHETTO DI LAMELLE ALLA GUIDA

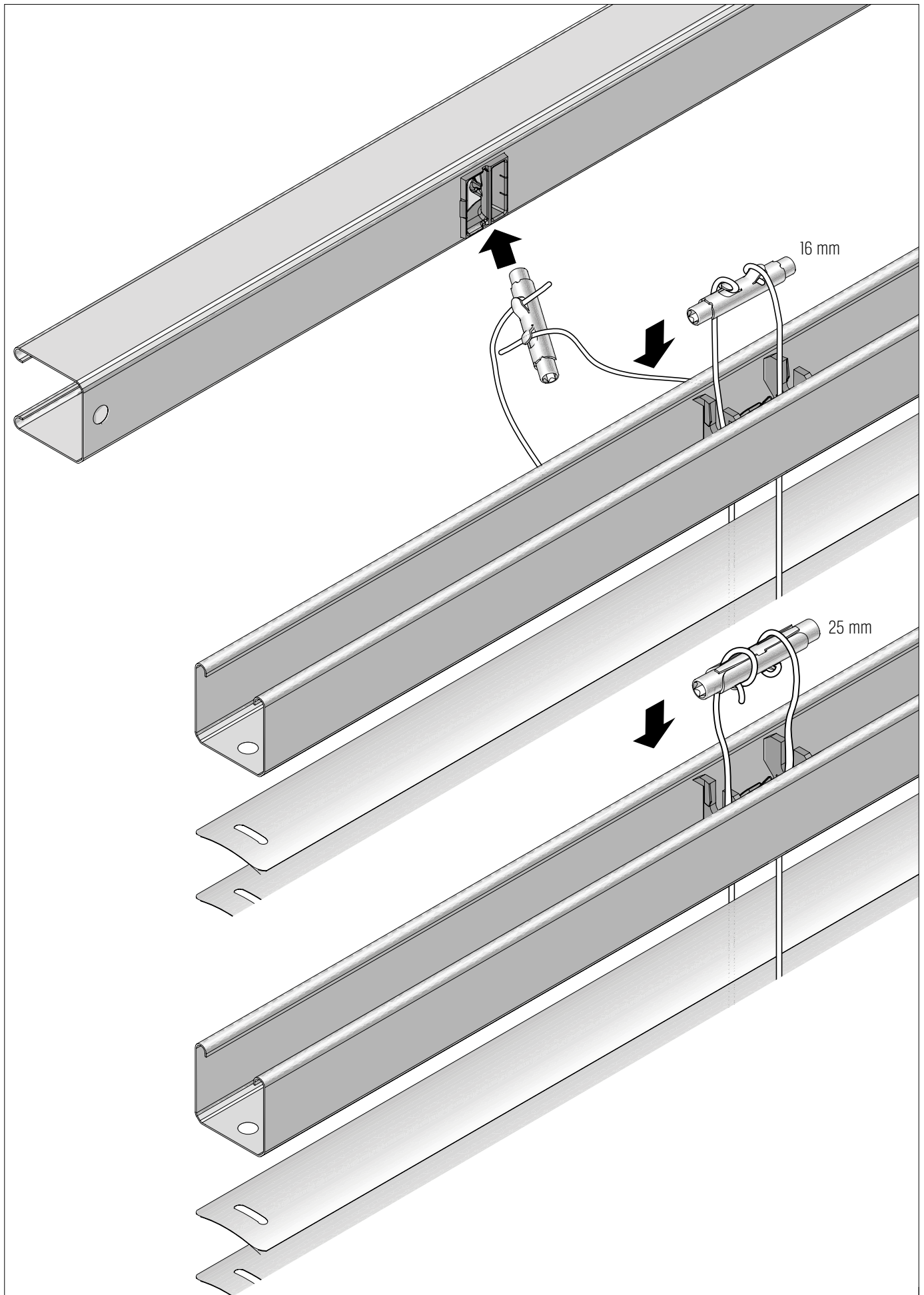

15. ATTACCARE IL PACCHETTO DOGHE ALLA GUIDA INFERIORE

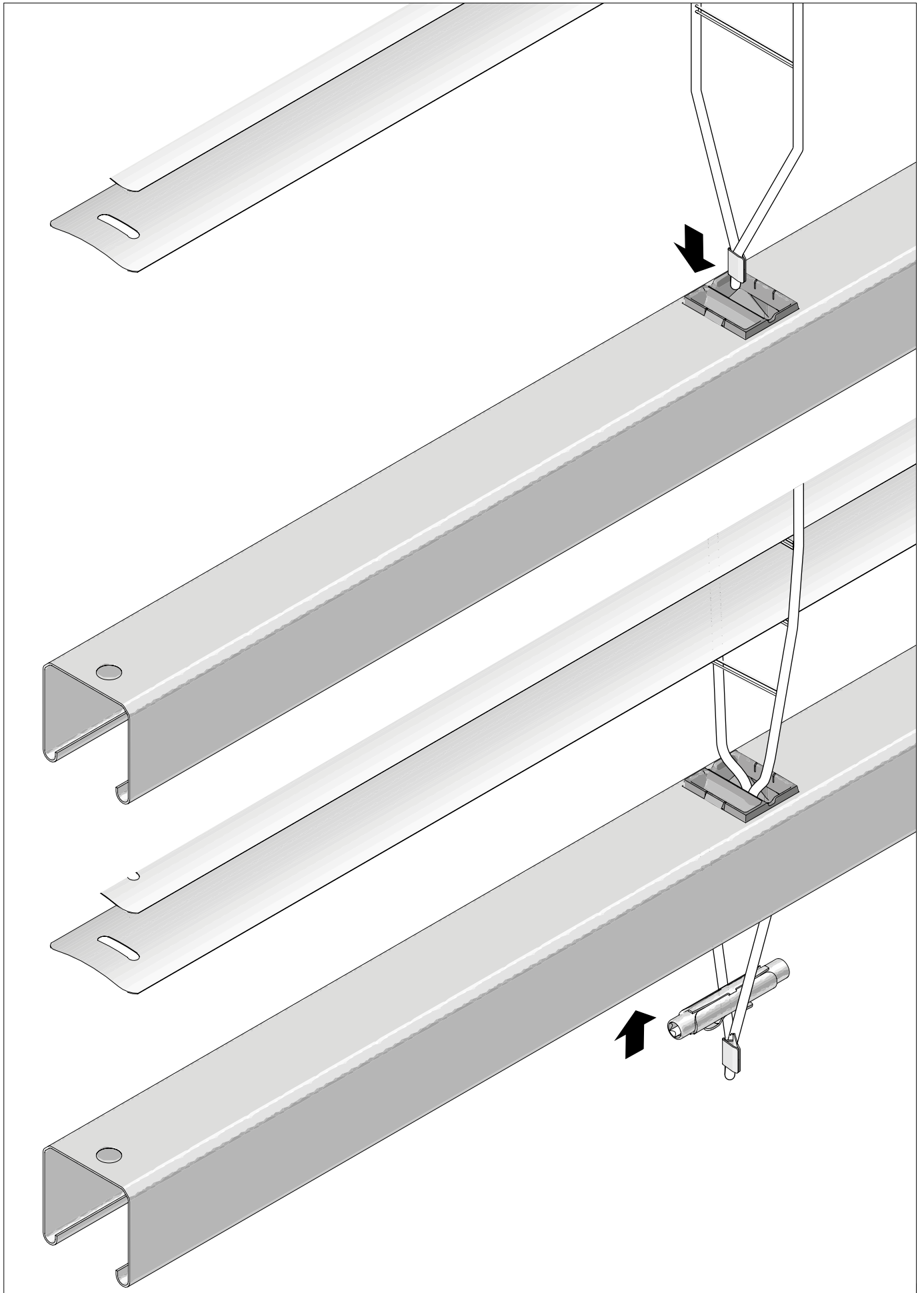

16. POSIZIONA IL RIBALTATORE

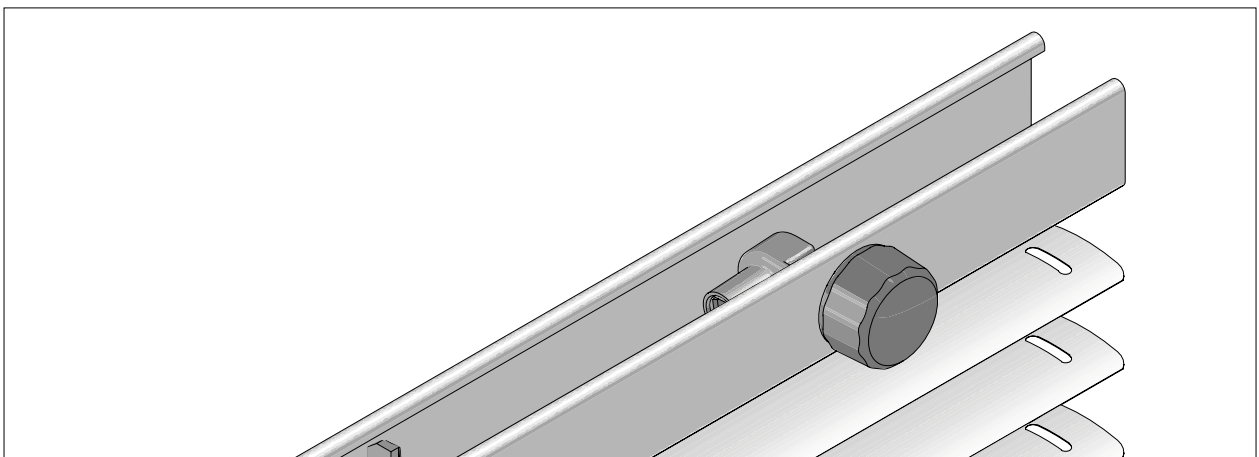
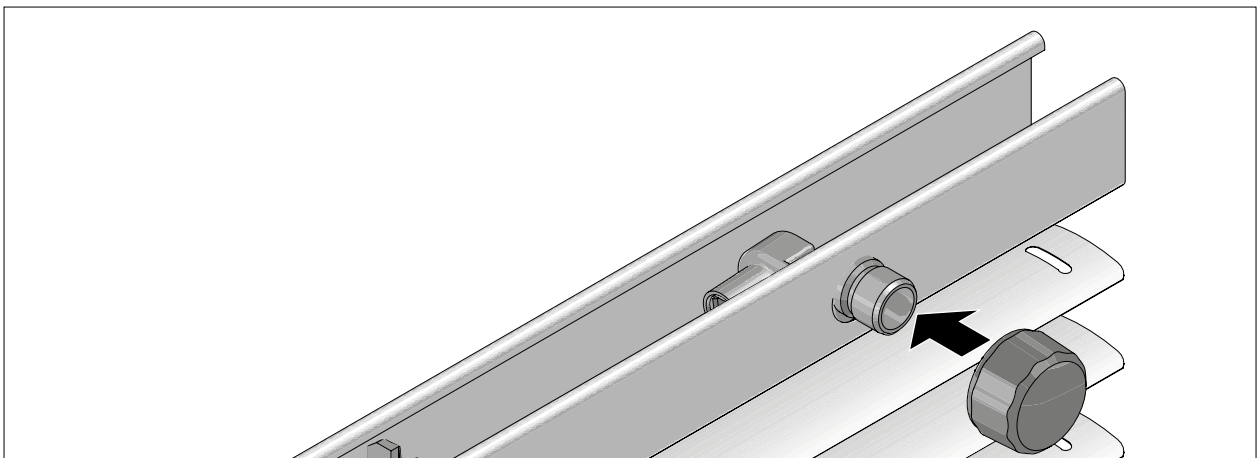
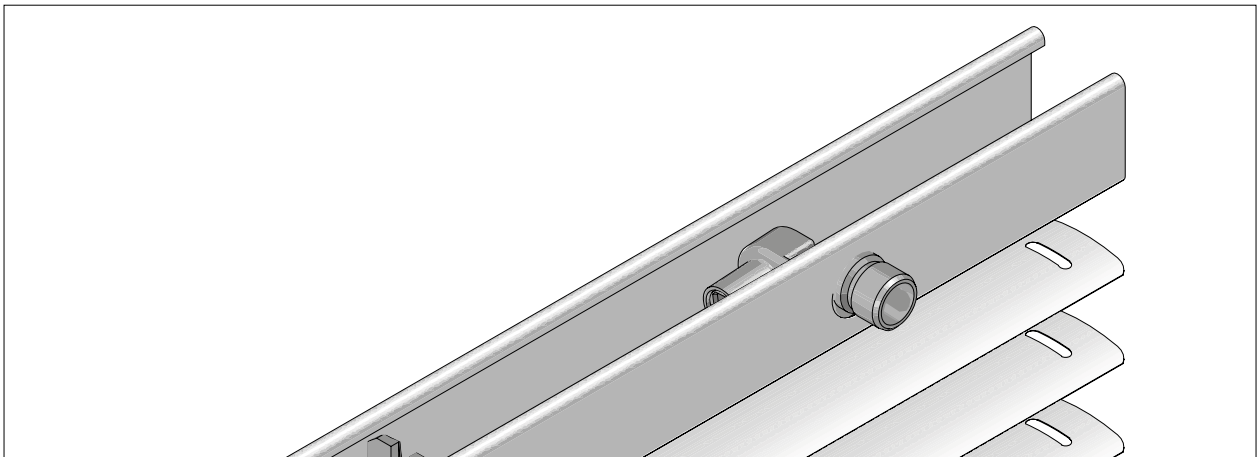
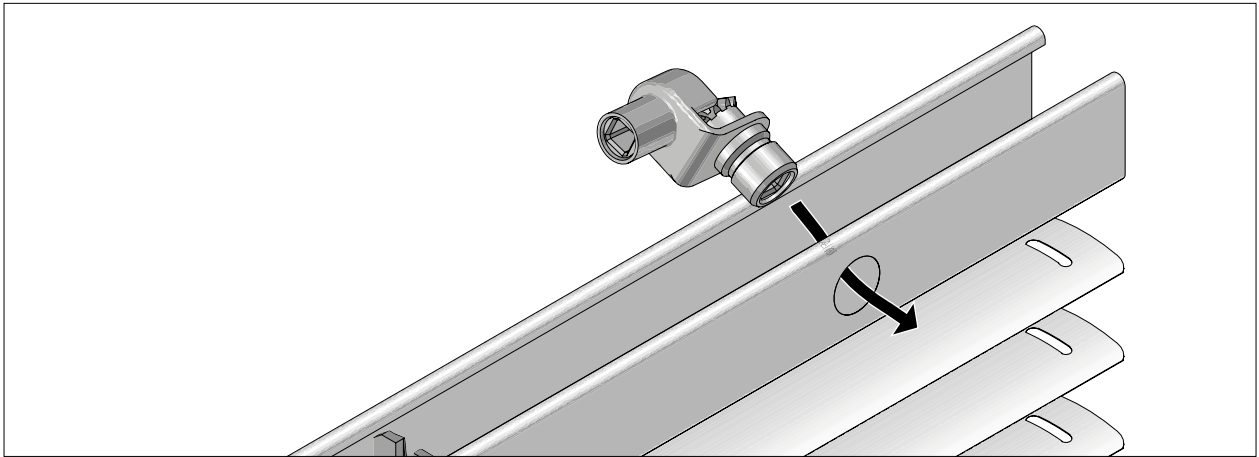

17. POSIZIONA IL TILTROD

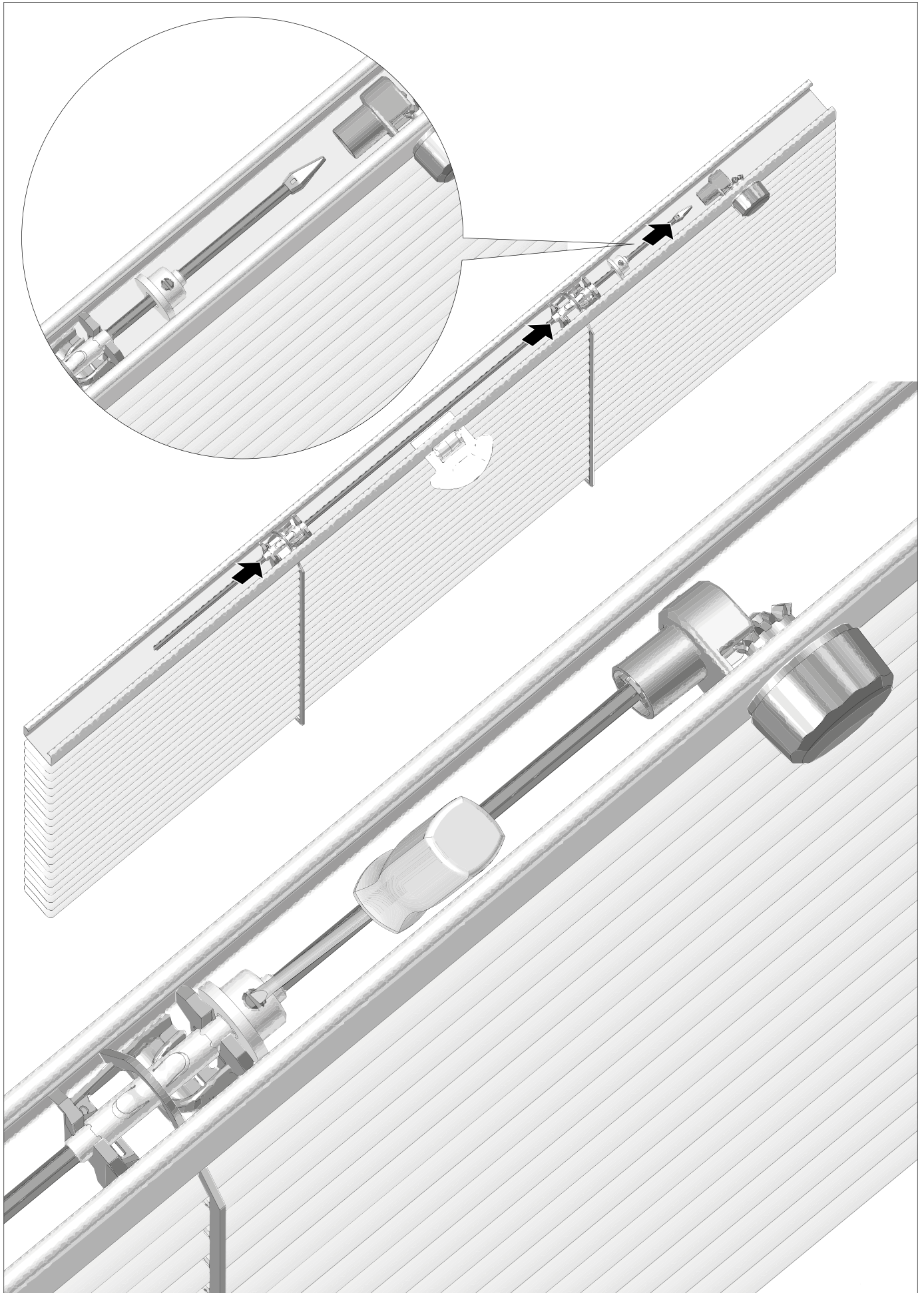

18. ALIMENTARE I CAVI DI TENSIONE

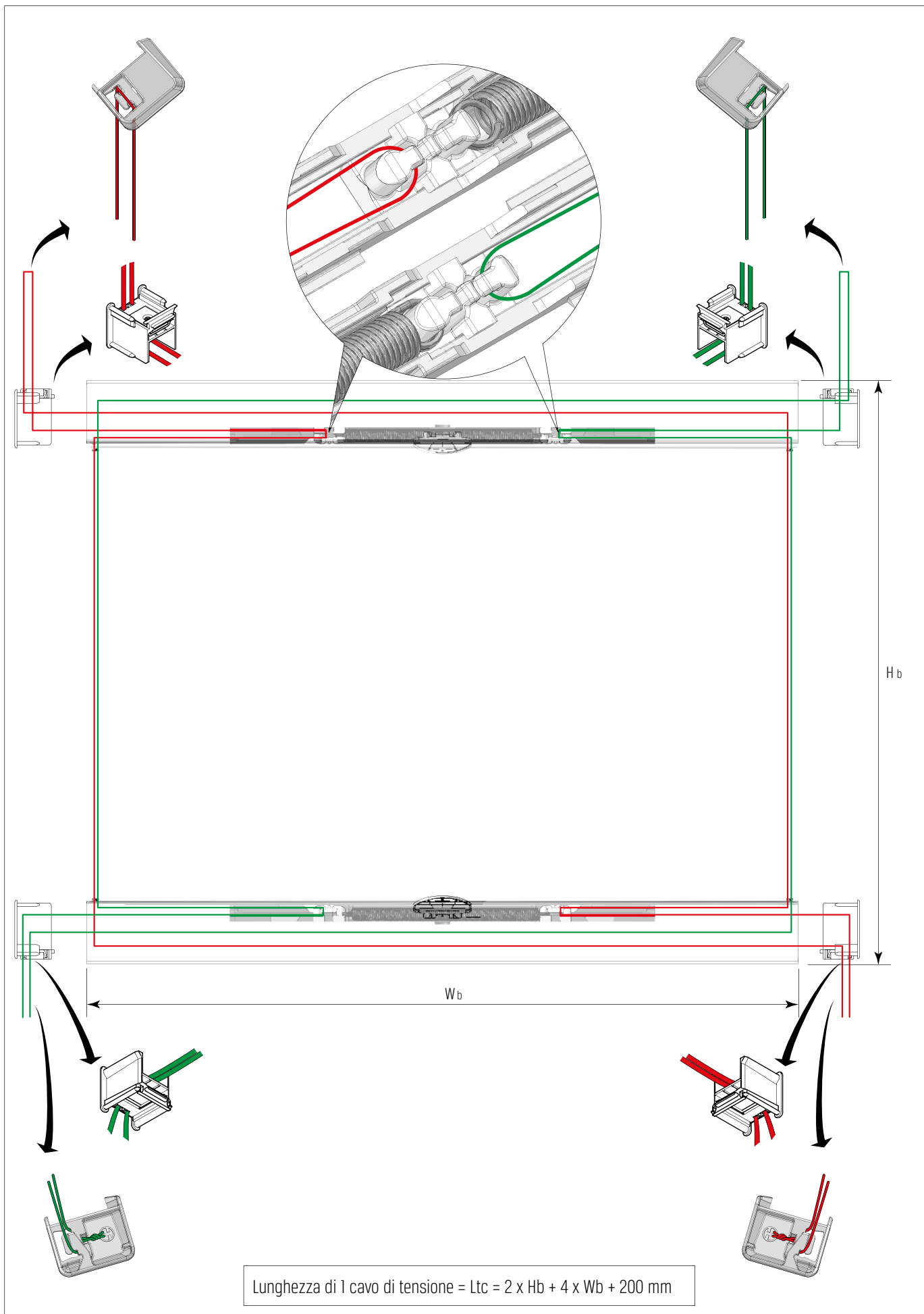

19. ATTACCARE LE UNITÀ A MOLLA

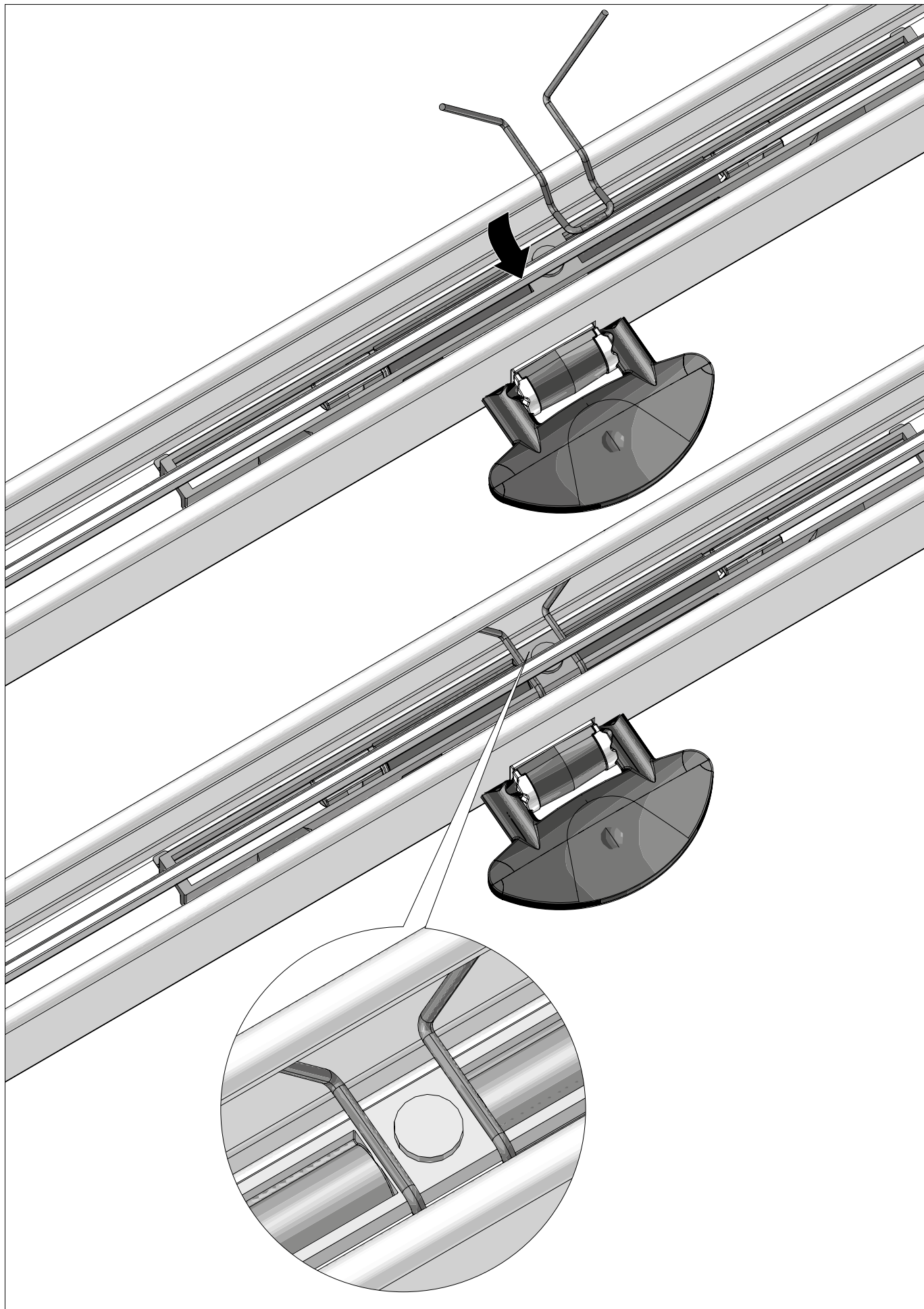

20. INSERIRE I TERMINALI

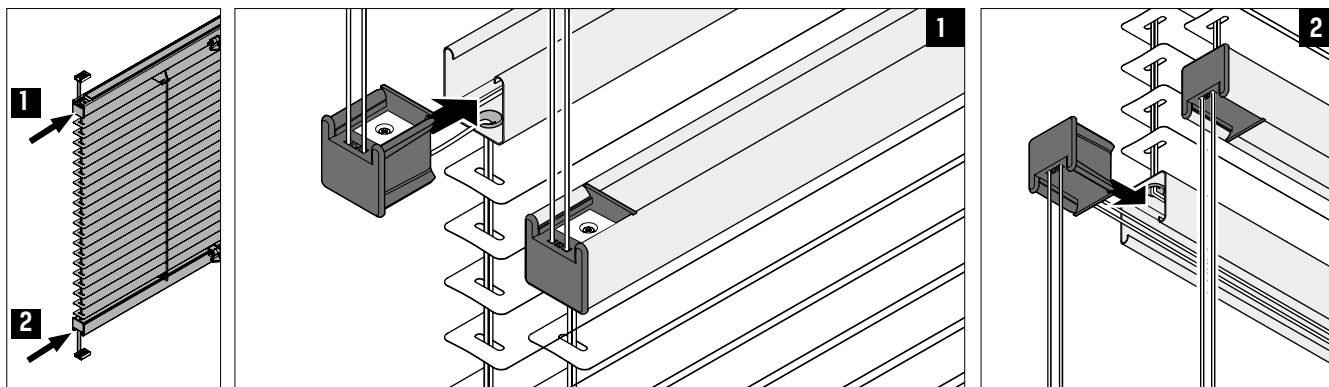

21. INSERIRE LE DOGHE DI FINITURA

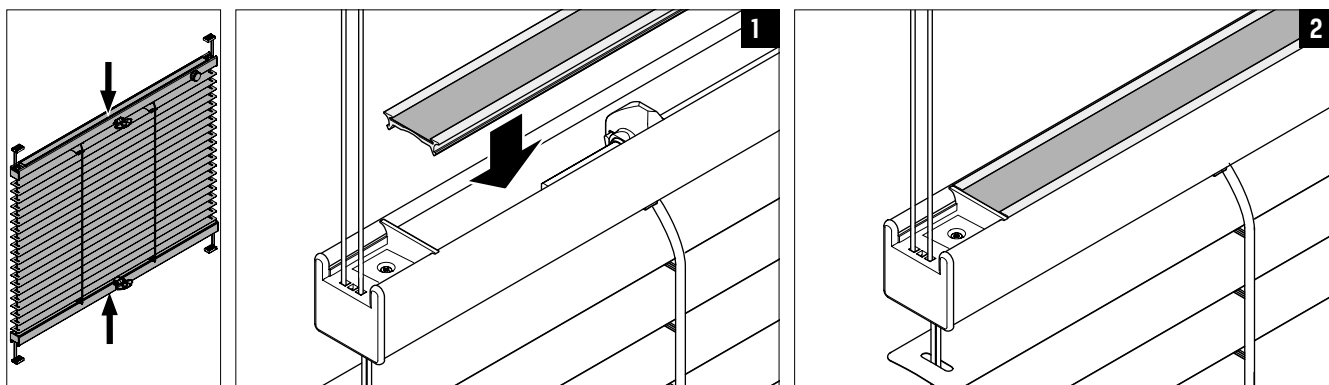

22. POSIZIONARE I DISTANZIATORI DEL NASTRO

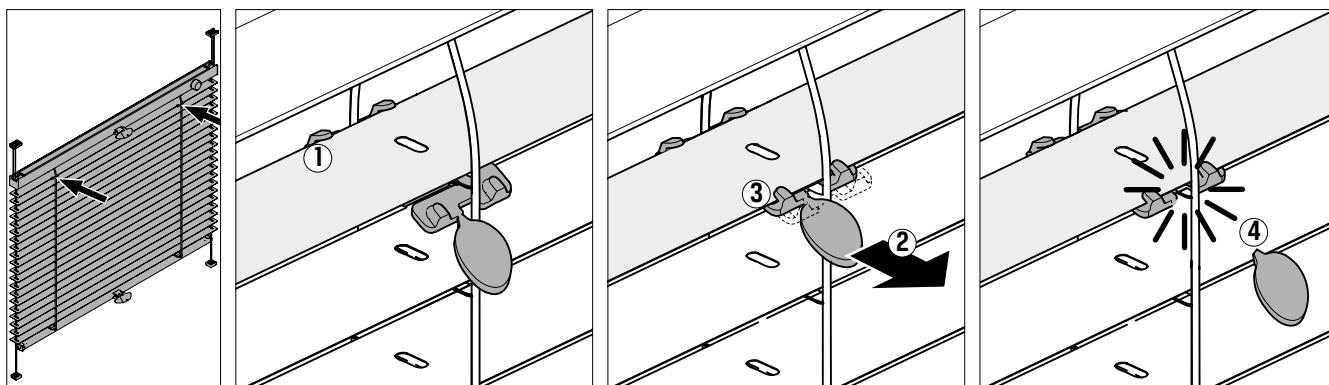

23. POSIZIONA LE STAFFE NEL PROFILO C

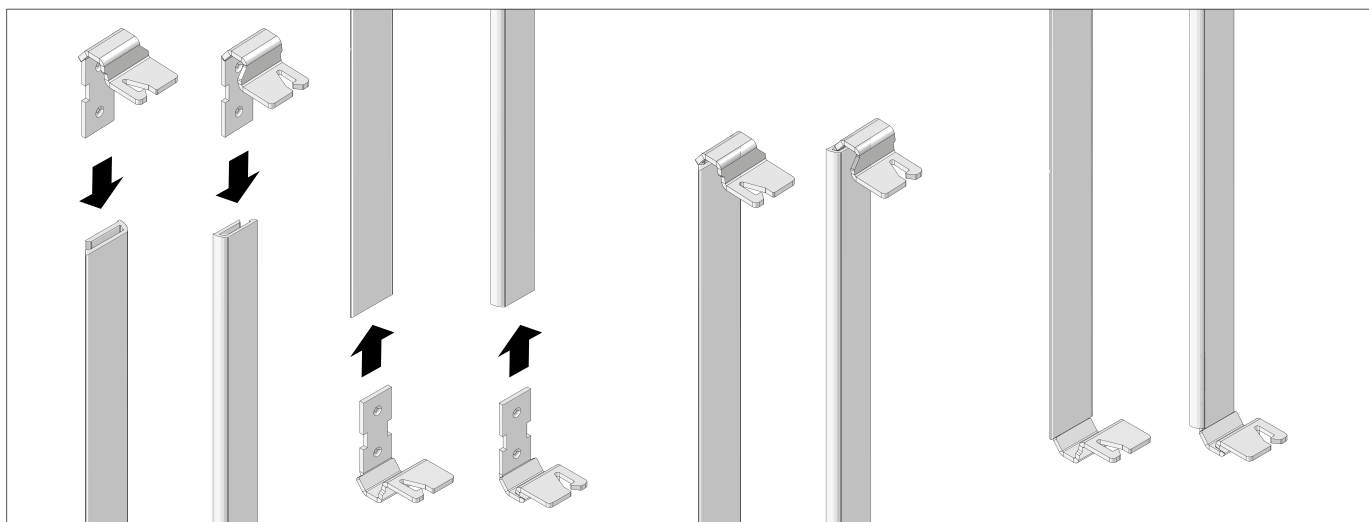

/ 5 MONTAGGIO

Salvietta per la pulizia NB
(246536)

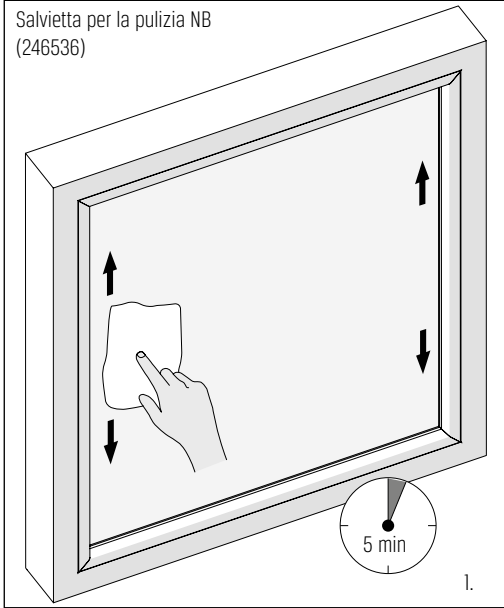

1.

Opzionale. Se il silicone viene utilizzato
sulla finestra o nella stanza,
utilizzare il nastro premier anti-silicone
(246545)

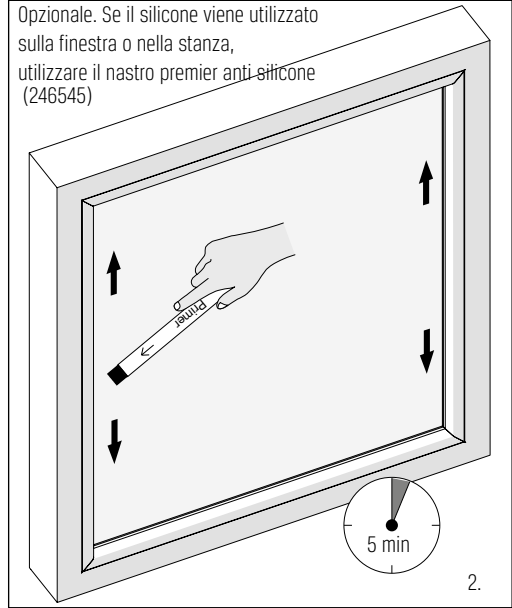

2.

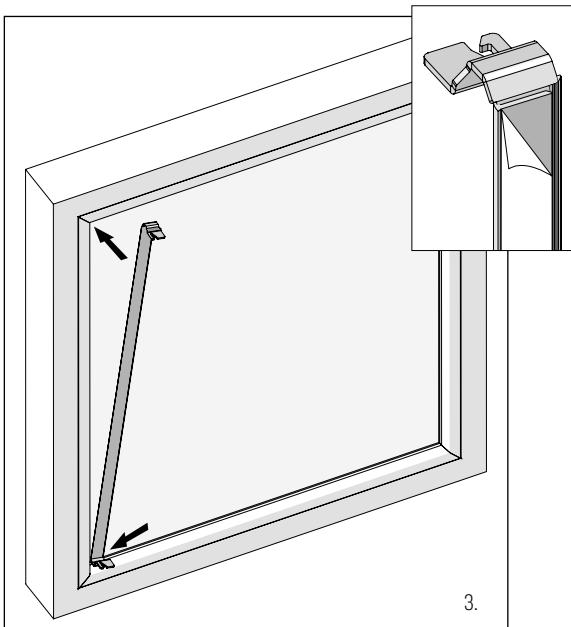

3.

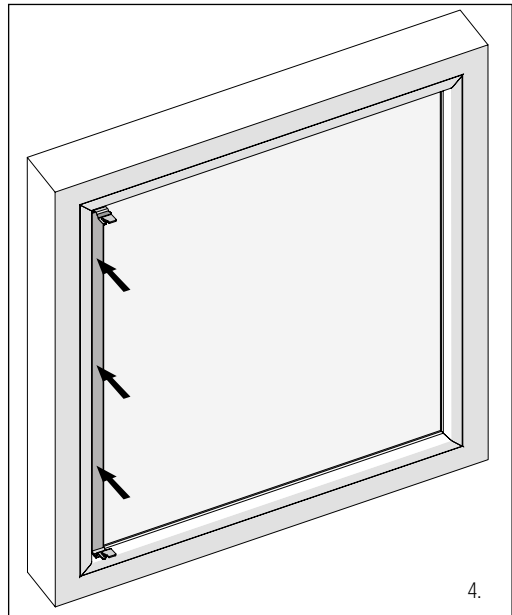

4.

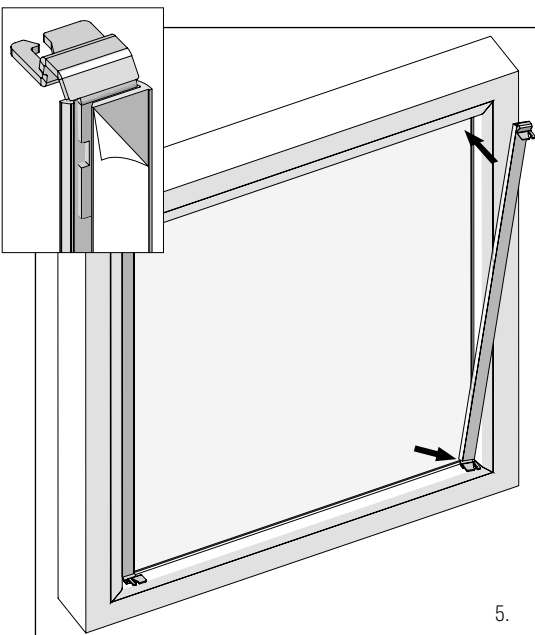

5.

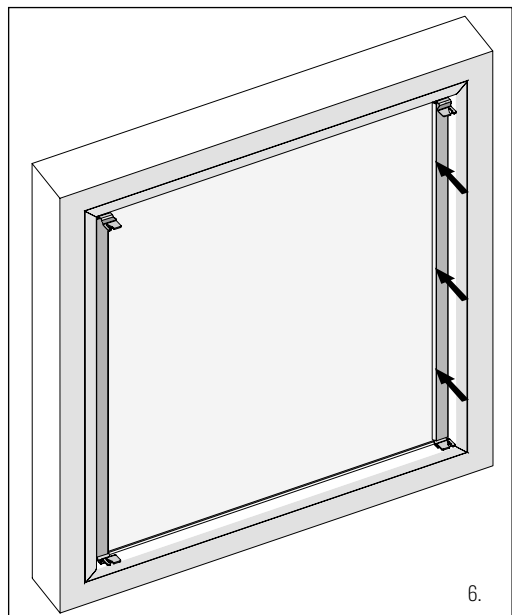

6.

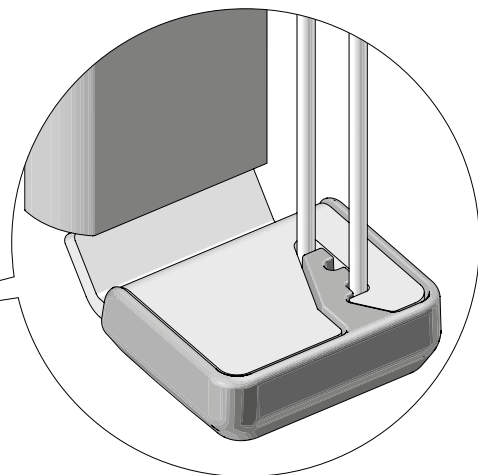
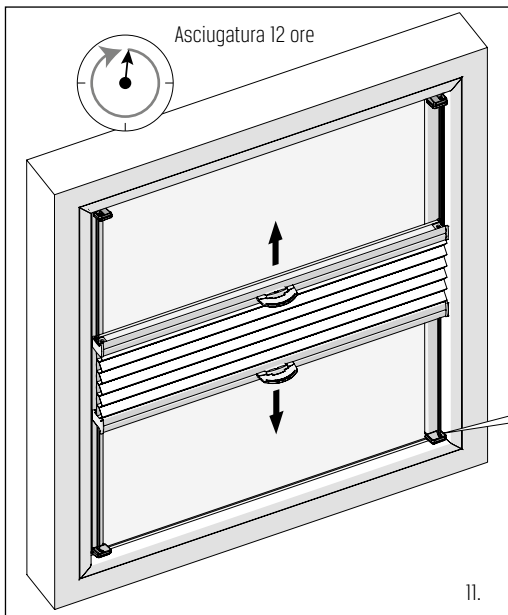
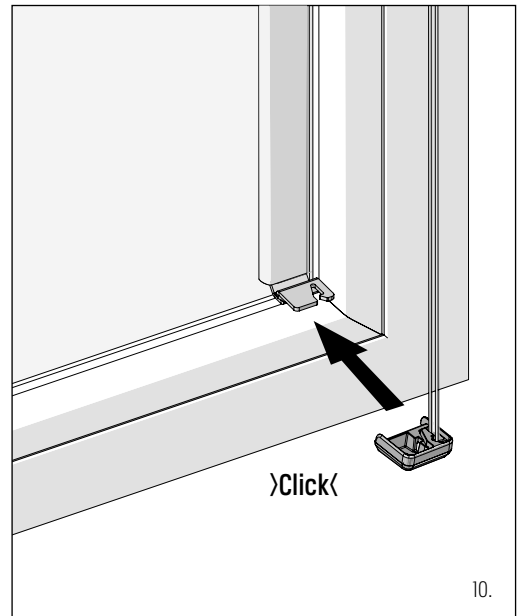
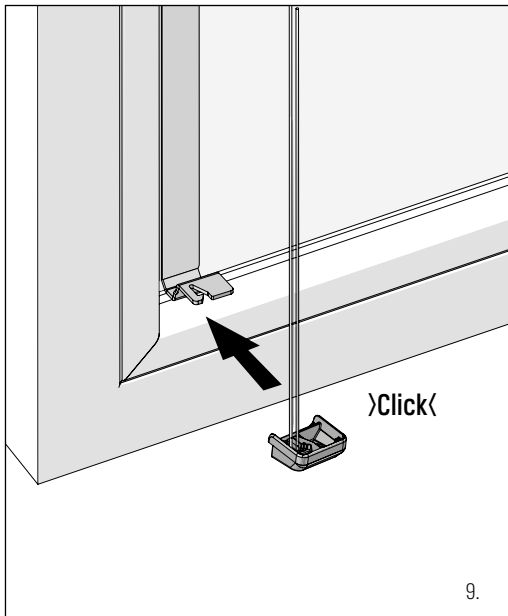
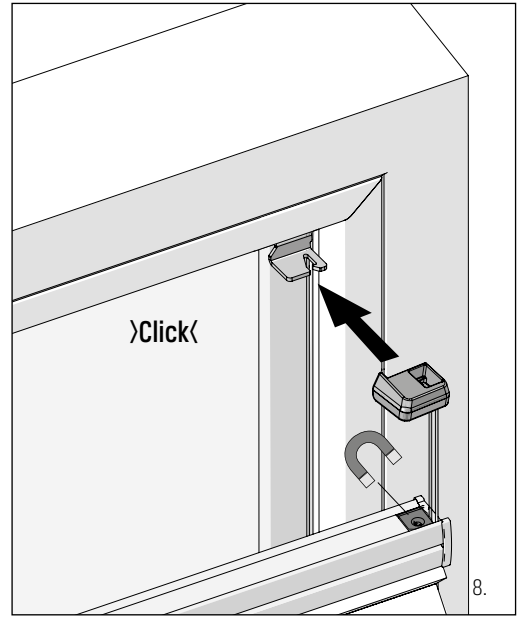
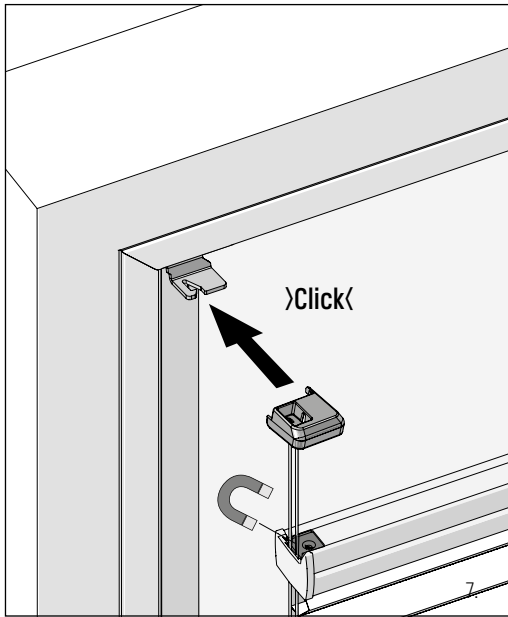

Smontaggio

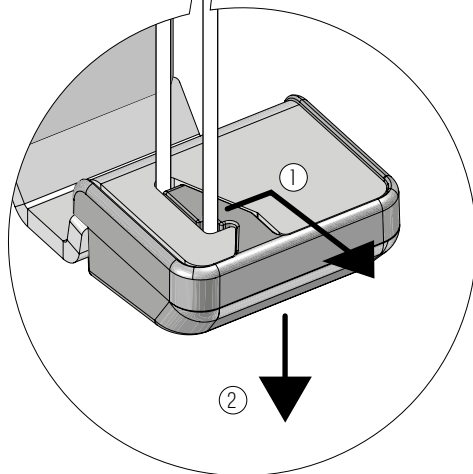
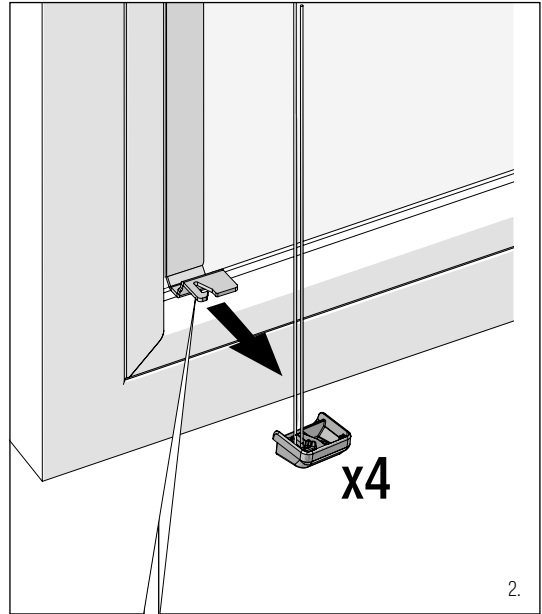
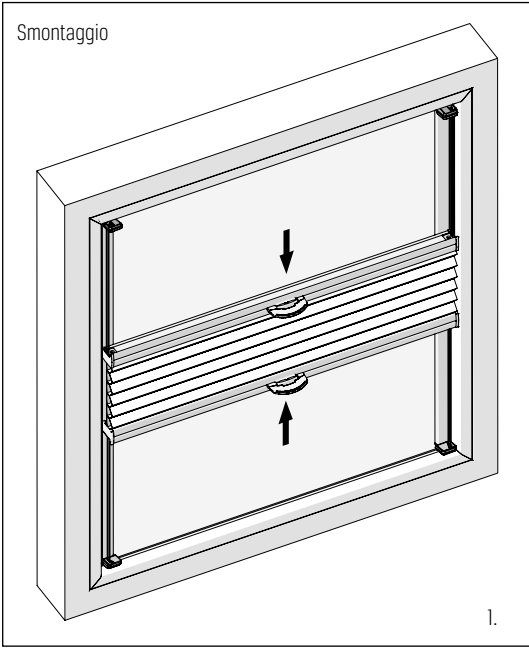

PLASTIND'S

since 1955



Via Giovanni Papini, 12, 40128 Bologna BO

TEL. 051 322188